

# LAND AUCTION

**4,467.58 ACRES OF CONTIGUOUS CROP LAND  
IN SULLY COUNTY, SOUTH DAKOTA  
TO BE SOLD IN 14 TRACTS  
LIVE AUCTION WITH ONLINE BIDDING AVAILABLE**

**TUESDAY, AUGUST 23<sup>RD</sup>, 2022 at 1:00 PM CT**

**Auction location: "83 AG" SALES AND SERVICE -  
18495 US HWY 83, ONIDA, SD**

**DEAN A. NELSON FARMS, INC.**



**To obtain complete details, a personal showing,  
or a bidder's packet, contact:**

**JOE SOVELL, BROKER ASSOCIATE**

**License #12502**

**Ph: 605-258-2828 Cell: 605-280-7656**

**[actionbuyersresource.com](http://actionbuyersresource.com)**

**Emily Sovell, Responsible Broker**

**ACTION BUYERS RESOURCE**

**P.O. Box 505**

**Onida, SD 57564**

**1-605-258-2828**

**Toll Free: 1-866-867-7253**





# Nelson Family Legacy



1979



1988



1998

The Nelson Family's Sully County history began in 1883 as Swedish immigrants making the trek from the east coast to Chicago, and later to Spink County, SD. Enticed by homestead and tree claims in Sully County, Dean's ancestors settled in Blaine Township with the original quarter section in NW 28-114-76 becoming their homestead. President Benjamin Harrison signed the Homestead Certificate for the Nelsons' 160 acres in 1890.

Dean was born in Onida in 1926 and grew up on the Nelson family farm helping his father by driving tractors on steel wheels at such a young age he could hardly reach the pedals. During the summer he would drive a Model A truck when they were haying the fields. From harvesting to livestock production (and having the sheep shearers teach him to castrate lambs with his teeth – a fact he was oddly proud of) – he loved being a farmer and rancher. He was a brilliant businessman, gambler, world traveler, pilot, father, and friend to so many people he met throughout his adventurous life. Dean was a well-respected third generation farmer and earned numerous accolades, including the Century Farm in 2008. Although he traveled around the world from Japan to Egypt and many countries in between, his home and his legacy remains in the heart of Sully County.





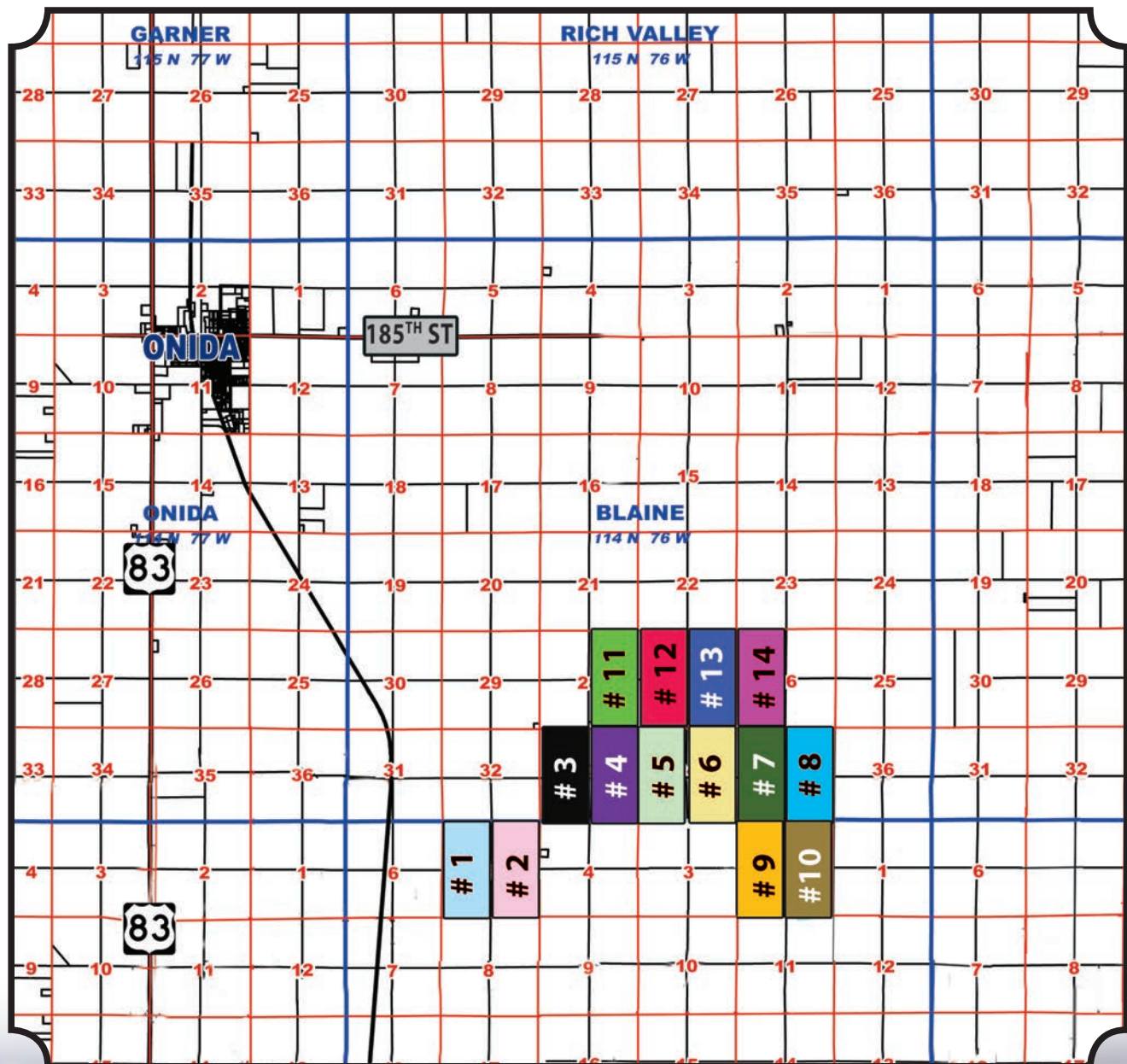

#### Auctioneers Notes:

Do not miss this extraordinary sale of the land legacy of Dean Nelson; an incredible 4,467.58-acres of prime farmland! This land is all contiguous and bodes solid County road access. It is a rarity to find such productive ag land --"farmed from one end of the field to the other without interruption or impediment!" Ample grain marketing opportunities are available. Sully County, SD, is home to two large grain elevators, an 80 million gallon/yr ethanol plant, and a 10,000 head cattle feedlot--all within a few miles of this property. This once in a lifetime offering will be parceled into fourteen tracts, providing prospective buyers the opportunity to buy acres that fit their needs.



## Terms:

1. A 10% nonrefundable earnest money payment at the conclusion of the auction, with balance due on or before closing. Closing shall occur on or before October 7th, 2022.
2. Possession at closing, subject to current lease terms.
3. A Buyer's Premium of 3% of the successful bid will be used to establish the final purchase price. The premium will be added to the successful bid amount, along with applicable state sales tax.
4. Marketable Title will be conveyed and an Owners Title Insurance Policy will be provided with the cost of the owner's policy and a title company closing fee, if any, to be divided 50-50 between Buyer(s) and Seller. Seller to pay transfer fees and Buyer(s) to pay recording fees.
5. This property is being sold based on the tax acres assessed by the Sully County Director of Equalization; this property is sold by legal description, subject to easements and restriction of record.
6. All of the 2022 real estate taxes payable in 2023 will be credited to the Buyer(s) by Seller at closing based upon the most current information available from the Sully County Director of Equalization at the time of the closing; Buyer(s) shall pay the 2022 real estate taxes due in 2023 and future real estate taxes.
7. The Seller does not provide warranty or guarantee that existing fences are located on the correct boundary. Location of field boundaries is the responsibility of the Buyer(s).
8. County data, Farm Service Agency reports, mapping, yields, bases, payments or data obtained for distribution is not guaranteed by Seller or Seller's agents. Information contained herein is deemed to be correct but is not guaranteed. The Sully County FSA will make final determination of all farm program crop bases and yields transferred to the Buyer(s).
9. Action Buyers Resource acts as agents for the Seller, and property sales are subject to confirmation of the owner.
10. If you are unable to attend and need to make arrangements to bid absentee by phone or on line, you must contact the auctioneer prior to sale day to make arrangements.

For additional information contact the auctioneers.

ALL ANNOUNCEMENTS MADE SALE DAY TAKE PRECEDENCE OVER ANY PREVIOUSLY DISCLOSED TERMS, CONDITIONS, OR DISCLOSURES, WHETHER ORALLY PROVIDED OR IN WRITING.

BROKER PARTICIPATION INVITED.





## TRACT 1

Legal Description: NW ¼ and the SW ¼ of Section 5-113-76, Sully County, SD

Total Taxable Acres: 318.90

Estimated FSA Cropland Acres: 308.03

Surety Productivity Index: 84.8

Real Estate Tax Amount: \$2,595.46

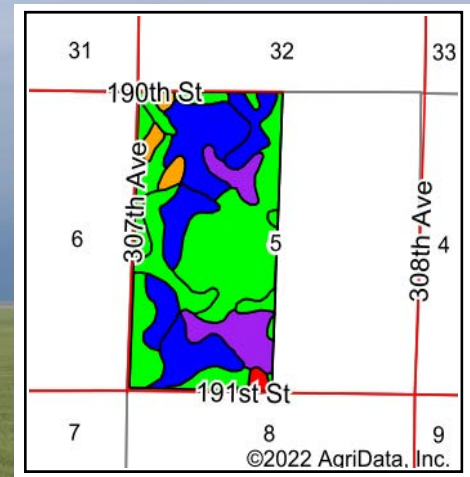

## TRACT 2

Legal Description: NE ¼ and the SE ¼ of Section 5-113-76, Sully County, SD

Total Taxable Acres: 318.26

Estimated FSA Cropland Acres: 308.04

Surety Productivity Index: 85.1

Real Estate Tax Amount: \$2,619.86

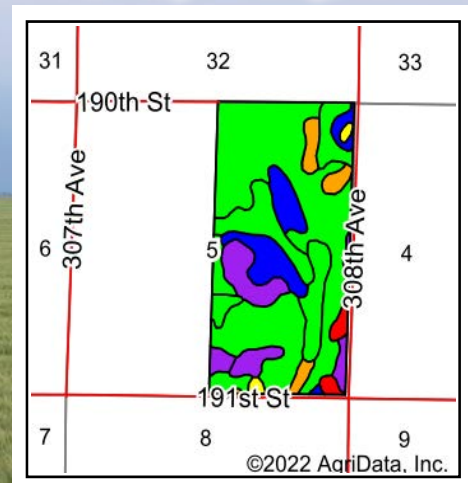



## TRACT 3

Legal Description: NW ¼ and the SW ¼ of Section 33-114-76, Sully County, SD

Total Taxable Acres: 319.67

Estimated FSA Cropland Acres: 311.03

Surety Productivity Index: 81.2

Real Estate Tax Amount: \$2,639.68

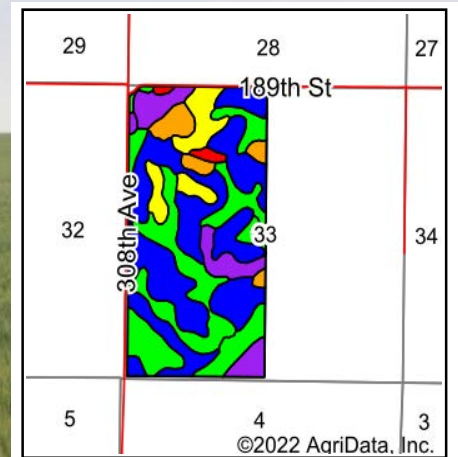

## TRACT 4

Legal Description: NE ¼ and the SE ¼ of Section 33-114-76, Sully County, SD

Total Taxable Acres: 320

Estimated FSA Cropland Acres: 311.04

Surety Productivity Index: 79.3

Real Estate Tax Amount: \$2,525.76

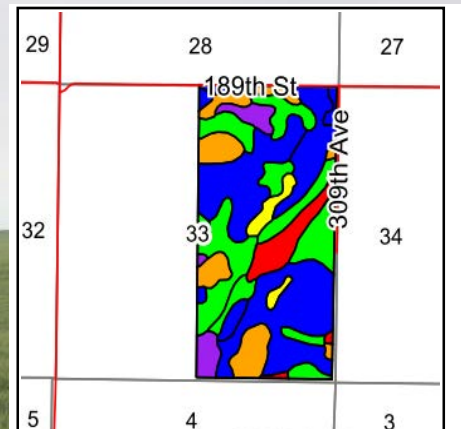



## TRACT 5

Legal Description: NW ¼ and the SW ¼ of Section 34-114-76, Sully County, SD

Total Taxable Acres: 320

Estimated FSA Cropland Acres: 293.4

Surety Productivity Index: 71.3

Real Estate Tax Amount: \$2,249.48

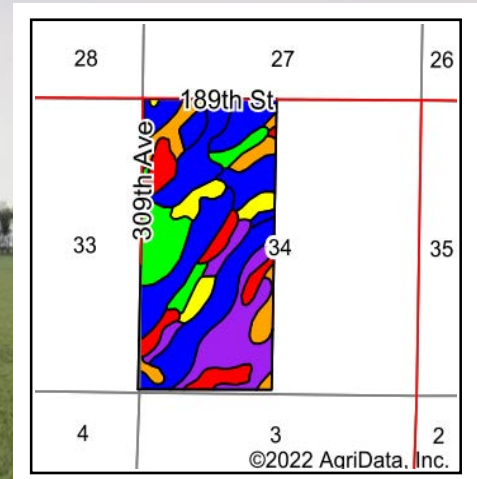

## TRACT 6

Legal Description: NE ¼ and the SE ¼ of Section 34-114-76, Sully County, SD

Total Taxable Acres: 320

Estimated FSA Cropland Acres: 323.46

Surety Productivity Index: 74.5

Real Estate Tax Amount: \$2,416.56

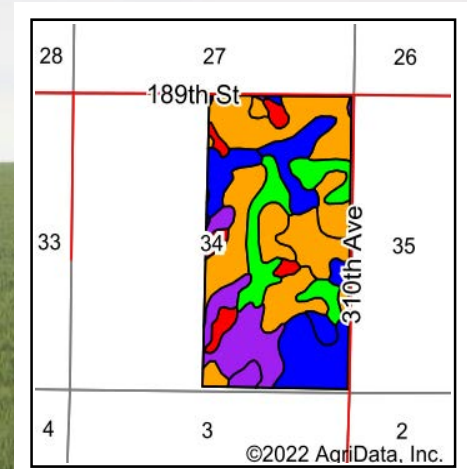



## TRACT 7

Legal Description: NW ¼ and the SW ¼ of Section 35-114-76, Sully County, SD

Total Taxable Acres: 320

Estimated FSA Cropland Acres: 316.32

Surety Productivity Index: 80.3

Real Estate Tax Amount: \$2,511.00

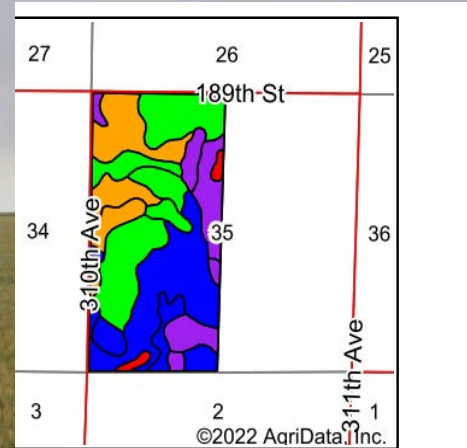

## TRACT 8

Legal Description: NE ¼ and the SE ¼ of Section 35-114-76, Sully County, SD

Total Taxable Acres: 320

Estimated FSA Cropland Acres: 316.32

Surety Productivity Index: 71

Real Estate Tax Amount: \$2,249.72

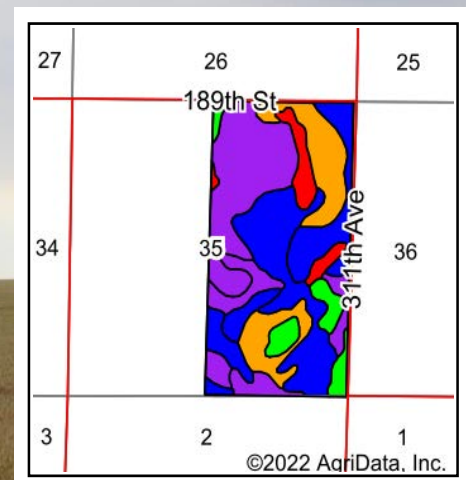



## TRACT 9

Legal Description: NW ¼ and the NW/SW Less Thompson Tract 1, and NE/SW & S ½ SW of 2-113-76, Sully County, SD

Total Taxable Acres: 313.98

Estimated FSA Cropland Acres: 280.38

Surety Productivity Index: 82.4

Real Estate Tax Amount: \$2,583.04

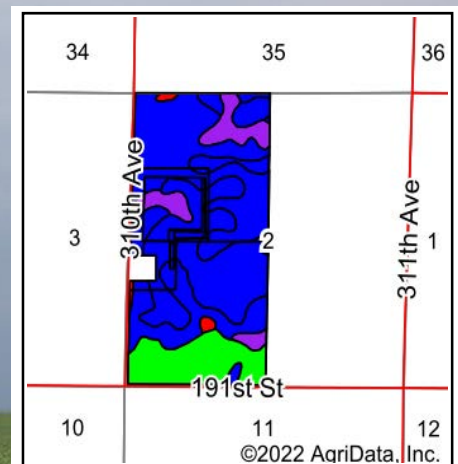

## TRACT 10

Legal Description: NE ¼ and the SE ¼ of Section 2-113-76, Sully County, SD

Total Taxable Acres: 319.69

Estimated FSA Cropland Acres: 313.30

Surety Productivity Index: 80.2

Real Estate Tax Amount: \$2,579.48

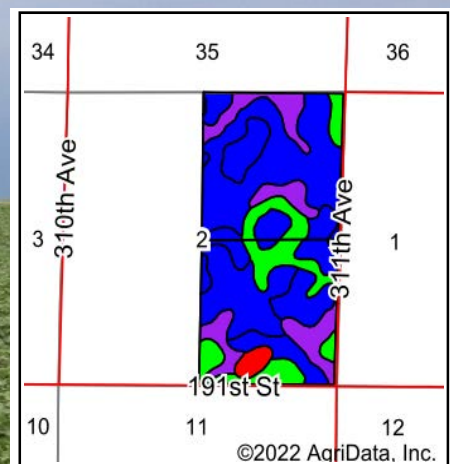



## TRACT 11

Legal Description: NE  $\frac{1}{4}$  and the SE  $\frac{1}{4}$  less W 336' of S 378' in Section 28-114-76, Sully County, SD

Total Taxable Acres: 317.08

Estimated FSA Cropland Acres: 314.75

Surety Productivity Index: 70.1

Real Estate Tax Amount: \$2,286.74

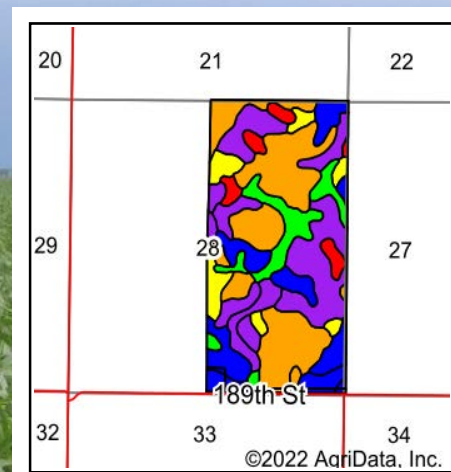

## TRACT 12

Legal Description: NW  $\frac{1}{4}$  and the SW  $\frac{1}{4}$  of Section 27-114-76, Sully County, SD

Total Taxable Acres: 320

Estimated FSA Cropland Acres: 315.93

Surety Productivity Index: 79.1

Real Estate Tax Amount: \$2,541.66

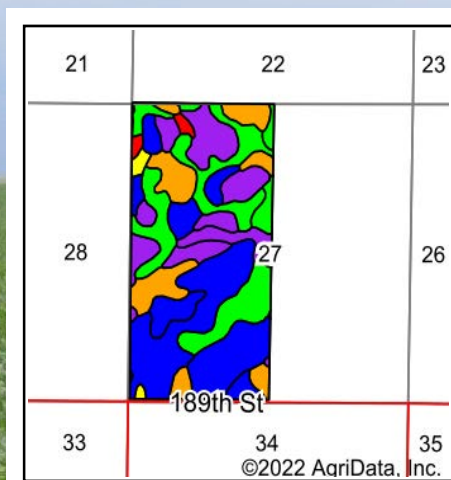



## TRACT 13

Legal Description: NE  $\frac{1}{4}$  and the SE  $\frac{1}{4}$  of Section 27-114-76, Sully County, SD

Total Taxable Acres: 320

Estimated FSA Cropland Acres: 315.94

Surety Productivity Index: 72.4

Real Estate Tax Amount: \$2,411.58

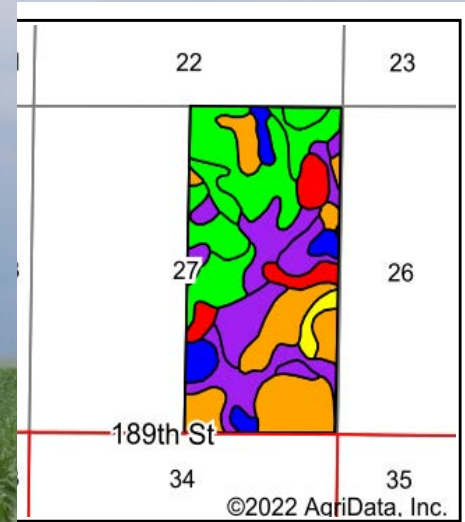

## TRACT 14

Legal Description: NW  $\frac{1}{4}$  and the SW  $\frac{1}{4}$  of Section 26-114-76, Sully County, SD

Total Taxable Acres: 320

Estimated FSA Cropland Acres: 308.17

Surety Productivity Index: 63.6

Real Estate Tax Amount: \$2,155.68

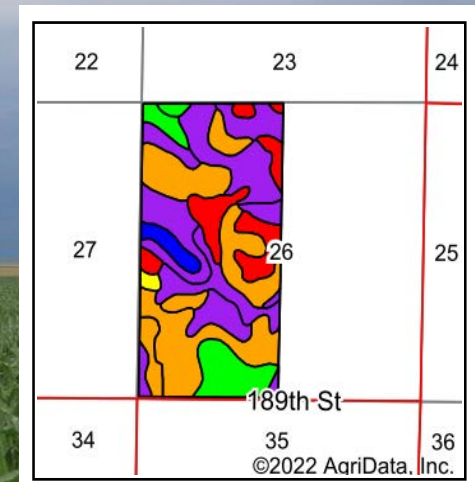



## ACTION BUYERS RESOURCE

P.O. Box 505  
Onida, SD 57564  
1-605-258-2828  
Toll Free: 1-866-867-7253



First Class  
US Postage  
Paid #35  
Pierre, SD

**JOIN US ON AUG 23<sup>rd</sup> FOR A 4,467 ACRE LAND AUCTION!!**





## ADDITIONAL TRACT INFORMATION

ALL TRACTS ARE CURRENTLY LEASED FOR THE 2022 CROP YEAR. THE CURRENT LEASE EXPIRES WHEN THE CROPS ARE HARVESTED IN THE SUMMER/FALL OF 2022.

**TRACT 1**

**TRACT 2**

**TRACT 3**

**TRACT 4**

**TRACT 5**

**TRACT 6**

THESE TRACTS ARE CURRENTLY PLANTED TO  
SPRING WHEAT FOR THE 2022 GROWING SEASON

**TRACT 7**

**TRACT 8**

THESE TRACTS ARE CURRENTLY PLANTED TO  
WINTER WHEAT FOR THE 2022 GROWING SEASON

**TRACT 9**

**TRACT 10**

THESE TRACTS ARE CURRENTLY PLANTED TO  
SUNFLOWERS FOR THE 2022 GROWING SEASON

**TRACT 11**

**TRACT 12**

**TRACT 13**

**TRACT 14**

THESE TRACTS ARE CURRENTLY PLANTED TO  
CORN FOR THE 2022 GROWING SEASON







United States  
Department of  
Agriculture

## Sully County, South Dakota

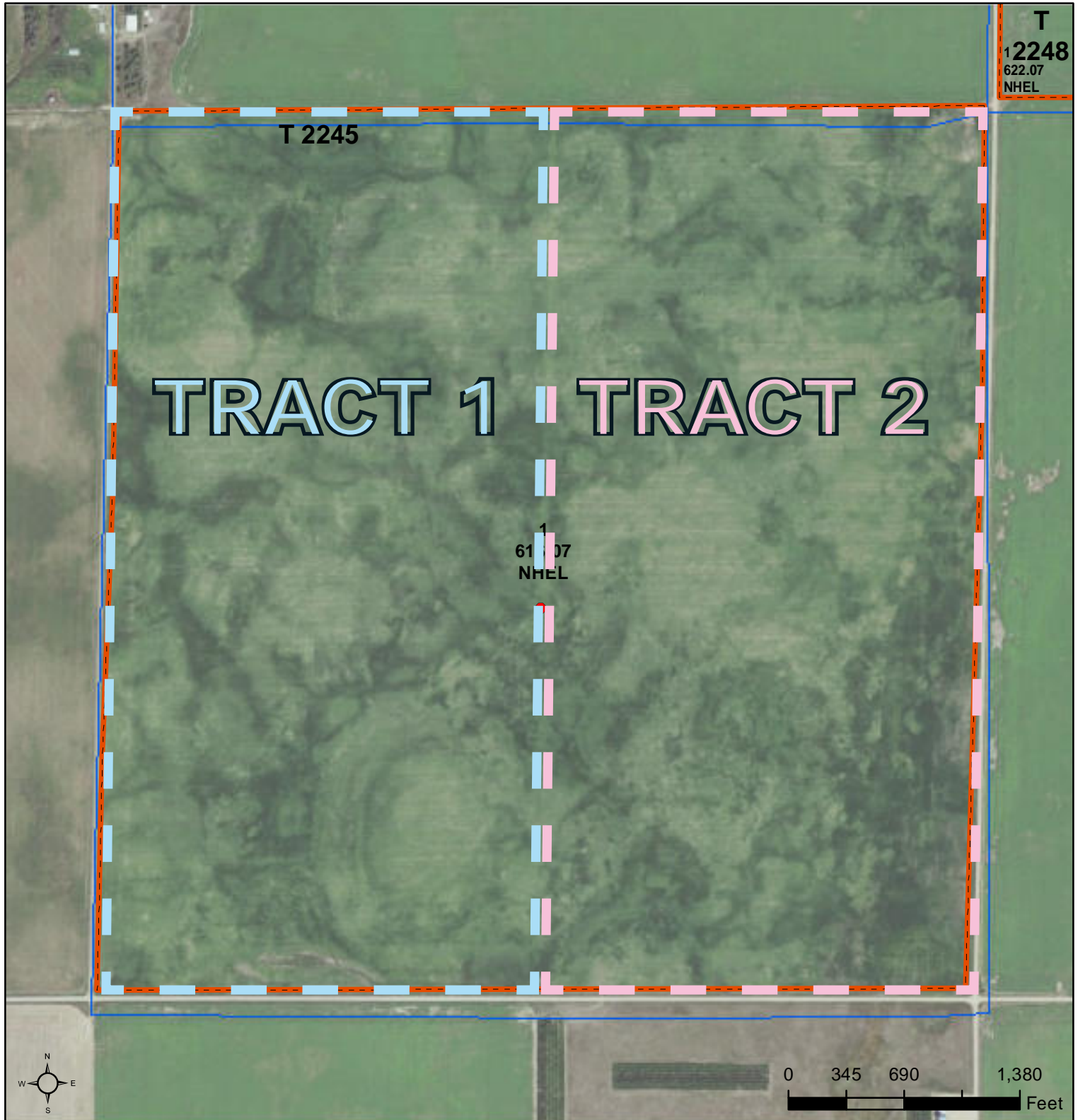

Common Land Unit   PLSS

- Cropland
- Tract Boundary

### Wetland Determination Identifiers

- Restricted Use
- ▼ Limited Restrictions
- Exempt from Conservation Compliance Provisions

United States Department of Agriculture (USDA) Farm Service Agency (FSA) maps are for FSA Program administration only. This map does not represent a legal survey or reflect actual ownership; rather it depicts the information provided directly from the producer and/or National Agricultural Imagery Program (NAIP) imagery. The producer accepts the data 'as is' and assumes all risks associated with its use. USDA-FSA assumes no responsibility for actual or consequential damage incurred as a result of any user's reliance on this data outside FSA Programs. Wetland identifiers do not represent the size, shape, or specific determination of the area. Refer to your original determination (CPA-026 and attached maps) for exact boundaries and determinations or contact USDA Natural Resources Conservation Service (NRCS).

2022 Program Year

Map Created May 03, 2022

Farm **5366**

**5-113N-76W-Sully**



# TRACT 1

## Soils Map

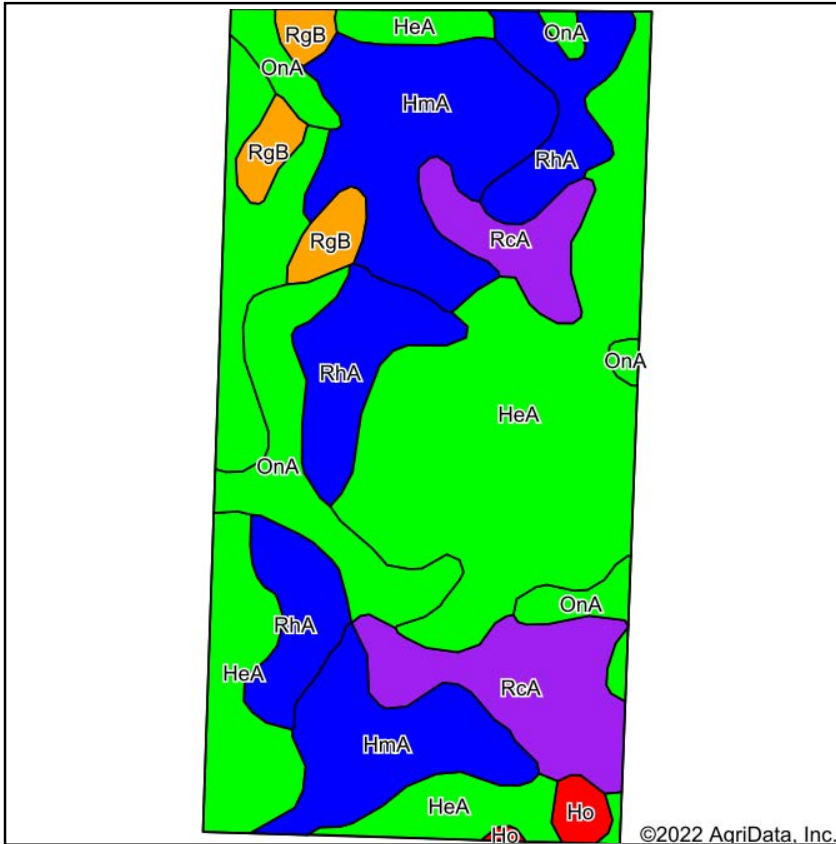

Soils data provided by USDA and NRCS.

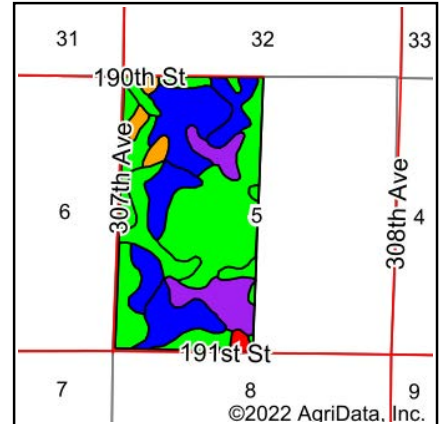

State: **South Dakota**  
 County: **Sully**  
 Location: **5-113N-76W**  
 Township: **East Sully**  
 Acres: **314.41**  
 Date: **7/5/2022**



Maps Provided By:



Area Symbol: SD119, Soil Area Version: 24

Code	Soil Description	Acres	Percent of field	PI Legend	Non-Irr Class *c	Productivity Index
HeA	Highmore silt loam, 0 to 2 percent slopes	132.89	42.3%		IIc	92
HmA	Highmore-Walke silt loams, 0 to 2 percent slopes	59.39	18.9%		IIc	85
RhA	Eakin-Raber complex, 0 to 2 percent slopes	41.47	13.2%		IIc	83
RcA	Raber-Cavo loams, 0 to 2 percent slopes	35.13	11.2%		IIc	60
OnA	Mobridge silt loam, 0 to 2 percent slopes	31.73	10.1%		IIc	94
RgB	Eakin-Raber complex, 2 to 6 percent slopes	10.45	3.3%		Ile	76
Ho	Hoven silt loam, 0 to 1 percent slopes	3.35	1.1%		VIIs	15
<b>Weighted Average</b>					<b>2.04</b>	<b>84.8</b>

\*c: Using Capabilities Class Dominant Condition Aggregation Method  
 Soils data provided by USDA and NRCS.



# TRACT 2

## Soils Map

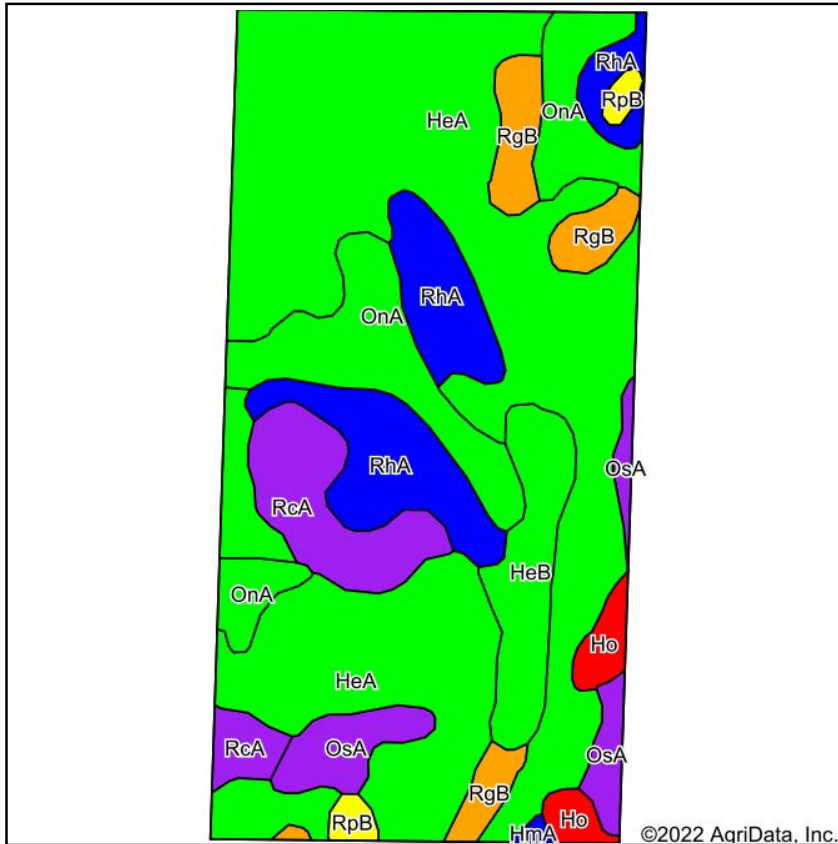

Soils data provided by USDA and NRCS.

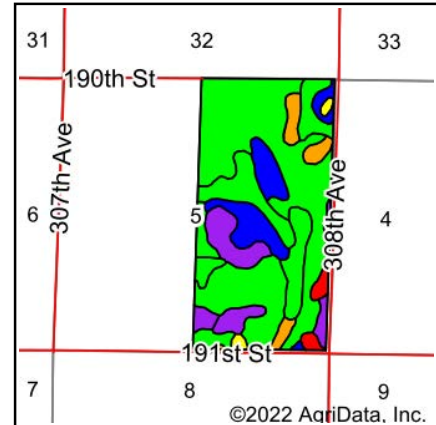

State: **South Dakota**  
 County: **Sully**  
 Location: **5-113N-76W**  
 Township: **East Sully**  
 Acres: **305.02**  
 Date: **7/5/2022**



Maps Provided By  
**surety**  
 CUSTOMIZED ONLINE MAPPING  
 © AgriData, Inc. 2021 www.AgriDataInc.com



Area Symbol: SD119, Soil Area Version: 24						
Code	Soil Description	Acres	Percent of field	PI Legend	Non-Irr Class *c	Productivity Index
HeA	Highmore silt loam, 0 to 2 percent slopes	161.56	53.0%		IIc	92
OnA	Mobridge silt loam, 0 to 2 percent slopes	36.58	12.0%		IIc	94
RhA	Eakin-Raber complex, 0 to 2 percent slopes	32.91	10.8%		IIc	83
RcA	Raber-Cavo loams, 0 to 2 percent slopes	20.67	6.8%		IIc	60
HeB	Highmore silt loam, 2 to 6 percent slopes	16.43	5.4%		Ile	91
RgB	Eakin-Raber complex, 2 to 6 percent slopes	14.10	4.6%		Ile	76
OsA	Onita-Hoven silt loams, 0 to 1 percent slopes	13.22	4.3%		IIc	59
Ho	Hoven silt loam, 0 to 1 percent slopes	5.90	1.9%		VIIs	15
RpB	Raber-Peno loams, 2 to 6 percent slopes	3.03	1.0%		Ile	65
HmA	Highmore-Walke silt loams, 0 to 2 percent slopes	0.62	0.2%		IIc	85
<b>Weighted Average</b>					<b>2.08</b>	<b>85.1</b>

\*c: Using Capabilities Class Dominant Condition Aggregation Method  
 Soils data provided by USDA and NRCS.





United States  
Department of  
Agriculture

## Sully County, South Dakota

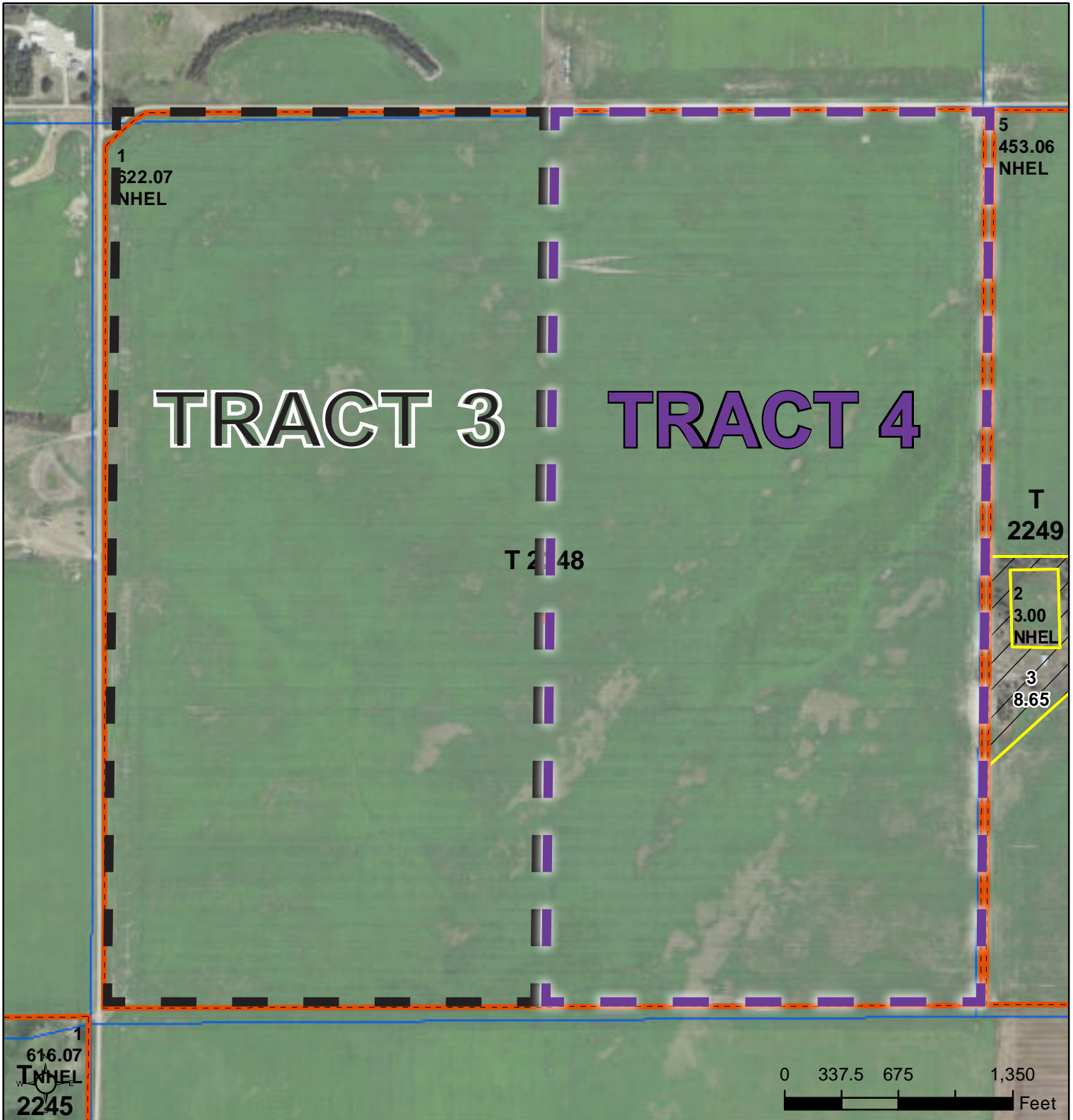

Common Land Unit ☐ PLSS

☐ Cropland

☐ Tract Boundary

Wetland Determination Identifiers

- ☐ Restricted Use
- ☐ Limited Restrictions
- ☐ Exempt from Conservation
- ☐ Compliance Provisions

2022 Program Year

Map Created May 03, 2022

Farm 5366

33-114N-76W-Sully

United States Department of Agriculture (USDA) Farm Service Agency (FSA) maps are for FSA Program administration only. This map does not represent a legal survey or reflect actual ownership; rather it depicts the information provided directly from the producer and/or National Agricultural Imagery Program (NAIP) imagery. The producer accepts the data 'as is' and assumes all risks associated with its use. USDA-FSA assumes no responsibility for actual or consequential damage incurred as a result of any user's reliance on this data outside FSA Programs. Wetland identifiers do not represent the size, shape, or specific determination of the area. Refer to your original determination (CPA-026 and attached maps) for exact boundaries and determinations or contact USDA Natural Resources Conservation Service (NRCS).



# TRACT 3

## Soils Map

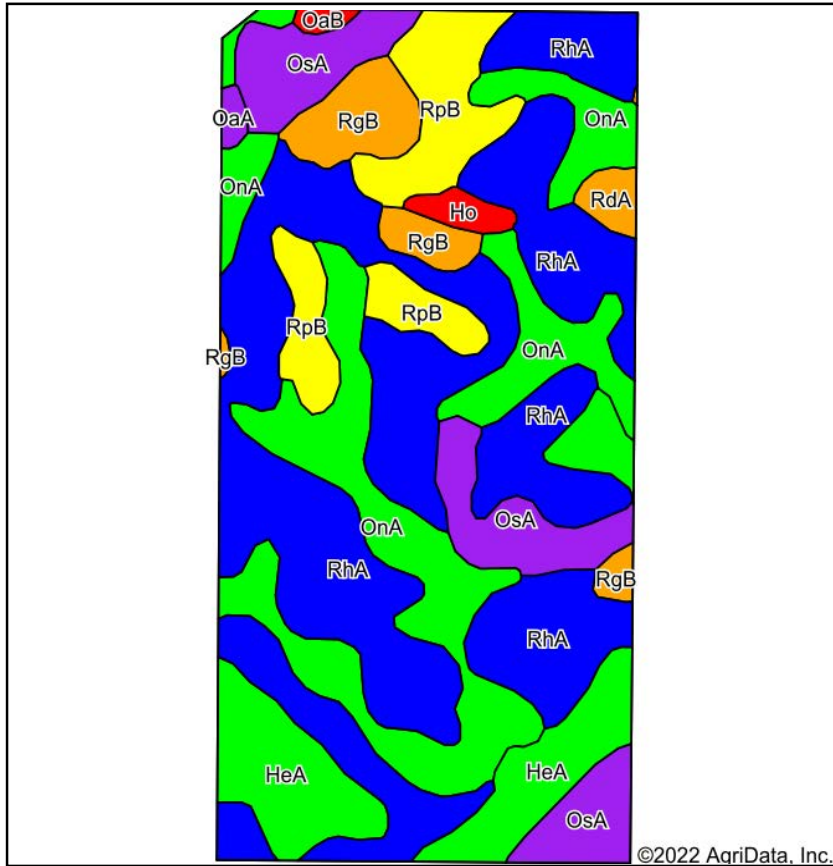

Soils data provided by USDA and NRCS.

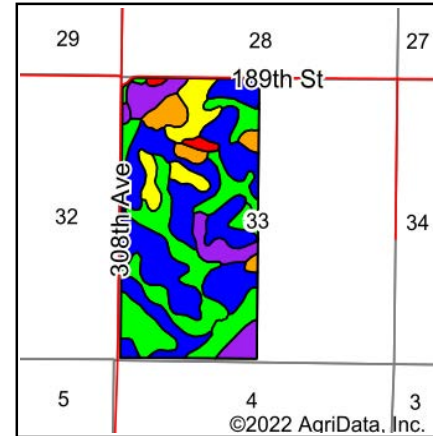

State: **South Dakota**  
 County: **Sully**  
 Location: **33-114N-76W**  
 Township: **East Sully**  
 Acres: **310.93**  
 Date: **7/5/2022**



Maps Provided By:



Area Symbol: SD119, Soil Area Version: 24						
Code	Soil Description	Acres	Percent of field	PI Legend	Non-Irr Class *c	Productivity Index
RhA	Eakin-Raber complex, 0 to 2 percent slopes	133.70	43.0%		IIc	83
OnA	Mobridge silt loam, 0 to 2 percent slopes	64.94	20.9%		IIc	94
HeA	Highmore silt loam, 0 to 2 percent slopes	33.62	10.8%		IIc	92
OsA	Onita-Hoven silt loams, 0 to 1 percent slopes	29.73	9.6%		IIc	59
RpB	Raber-Peno loams, 2 to 6 percent slopes	26.53	8.5%		IIe	65
RgB	Eakin-Raber complex, 2 to 6 percent slopes	14.46	4.7%		IIe	76
RdA	Raber-Demky loams, 0 to 2 percent slopes	2.84	0.9%		IIc	75
Ho	Hoven silt loam, 0 to 1 percent slopes	2.78	0.9%		VIIs	15
OaA	Oahe-Delmont loams, 0 to 2 percent slopes	1.22	0.4%		IIIs	52
OaB	Oahe-Delmont loams, 2 to 6 percent slopes	1.11	0.4%		IIle	46
Weighted Average					2.04	81.2

\*c: Using Capabilities Class Dominant Condition Aggregation Method  
 Soils data provided by USDA and NRCS.

# TRACT 4

## Soils Map

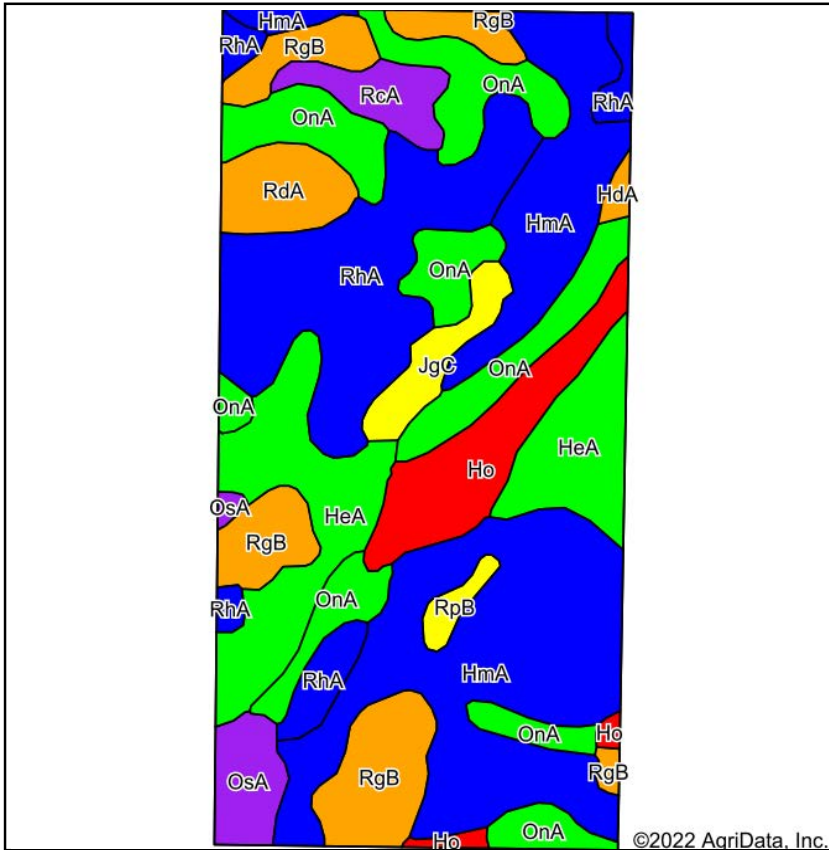

Soils data provided by USDA and NRCS.

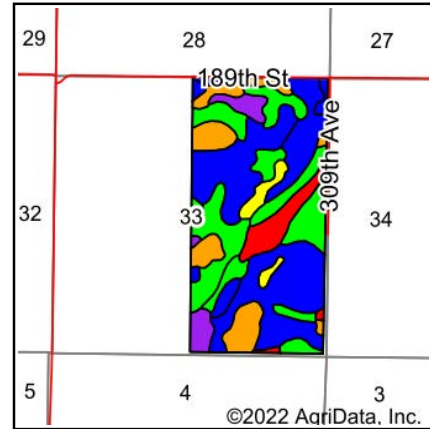

State: **South Dakota**  
 County: **Sully**  
 Location: **33-114N-76W**  
 Township: **East Sully**  
 Acres: **310.04**  
 Date: **7/5/2022**



Maps Provided By:  
**surety**  
 CUSTOMIZED ONLINE MAPPING  
 © AgriData, Inc. 2021 www.AgriDataInc.com



Area Symbol: SD119, Soil Area Version: 24

Code	Soil Description	Acres	Percent of field	PI Legend	Non-Irr Class *c	Productivity Index
HmA	Highmore-Walke silt loams, 0 to 2 percent slopes	84.89	27.4%		IIc	85
RhA	Eakin-Raber complex, 0 to 2 percent slopes	51.49	16.6%		IIc	83
OnA	Mobridge silt loam, 0 to 2 percent slopes	48.58	15.7%		IIc	94
HeA	Highmore silt loam, 0 to 2 percent slopes	39.71	12.8%		IIc	92
RgB	Eakin-Raber complex, 2 to 6 percent slopes	26.16	8.4%		Ile	76
Ho	Hoven silt loam, 0 to 1 percent slopes	19.75	6.4%		VIIs	15
RdA	Raber-Demky loams, 0 to 2 percent slopes	12.99	4.2%		IIc	75
OsA	Onita-Hoven silt loams, 0 to 1 percent slopes	8.17	2.6%		IIc	59
RcA	Raber-Cavo loams, 0 to 2 percent slopes	7.47	2.4%		IIc	60
JgC	Java-Glenham loams, 3 to 9 percent slopes	7.17	2.3%		IVe	63
RpB	Raber-Peno loams, 2 to 6 percent slopes	2.44	0.8%		Ile	65
HdA	Highmore-DeGrey silt loams, 0 to 2 percent slopes	1.22	0.4%		IIc	76
<b>Weighted Average</b>					<b>2.30</b>	<b>79.3</b>

\*c: Using Capabilities Class Dominant Condition Aggregation Method  
 Soils data provided by USDA and NRCS.



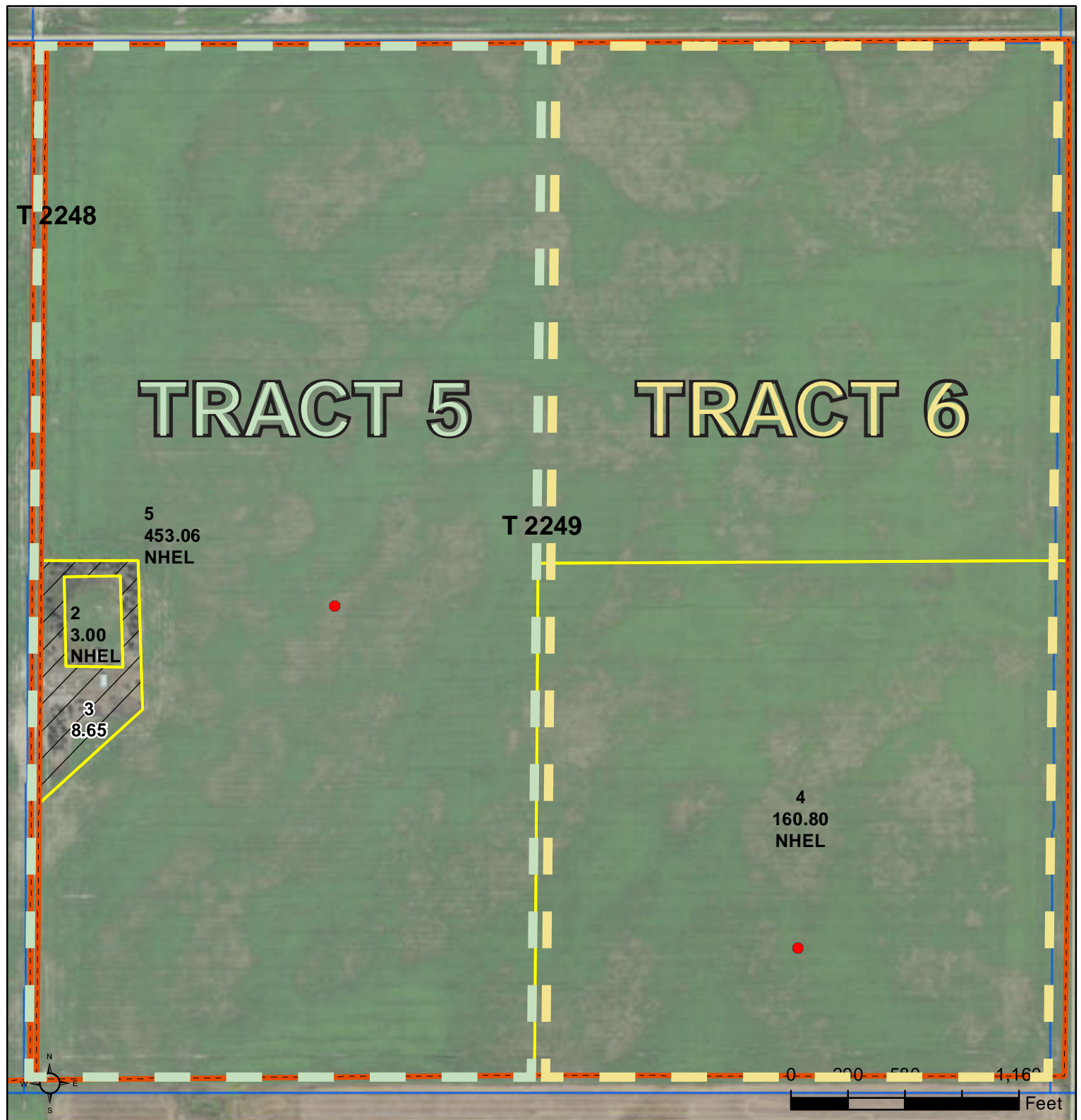

**Common Land Unit**  **Tract Boundary**

 Non-Cropland

☐ Cropland

Tract Boundary  
PLSS

### Wetland Determination Identifiers

 Restricted Use

▼ Limited Restrictions

Exempt from Conservation

### ■ Exempt from Conserva Compliance Provisions

2022 Program Year

Map Created May 03, 2022

Farm 5366

### 34-114N-76W-Sully

United States Department of Agriculture (USDA) Farm Service Agency (FSA) maps are for FSA Program administration only. This map does not represent a legal survey or reflect actual ownership; rather it depicts the information provided directly from the producer and/or National Agricultural Imagery Program (NAIP) imagery. The producer accepts the data 'as is' and assumes all risks associated with its use. USDA-FSA assumes no responsibility for actual or consequential damage incurred as a result of any user's reliance on this data outside FSA Programs. Wetland identifiers do not represent the size, shape, or specific determination of the area. Refer to your original determination (CPA-026 and attached maps) for exact boundaries and determinations or contact USDA Natural Resources Conservation Service (NRCS).

# TRACT 5

## Soils Map

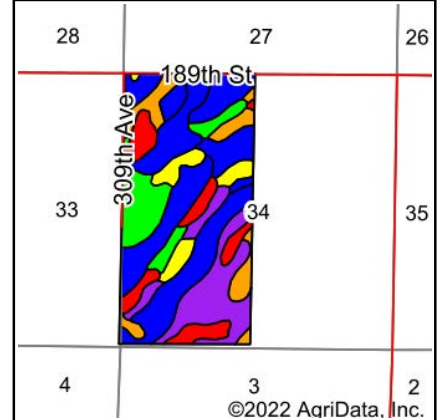
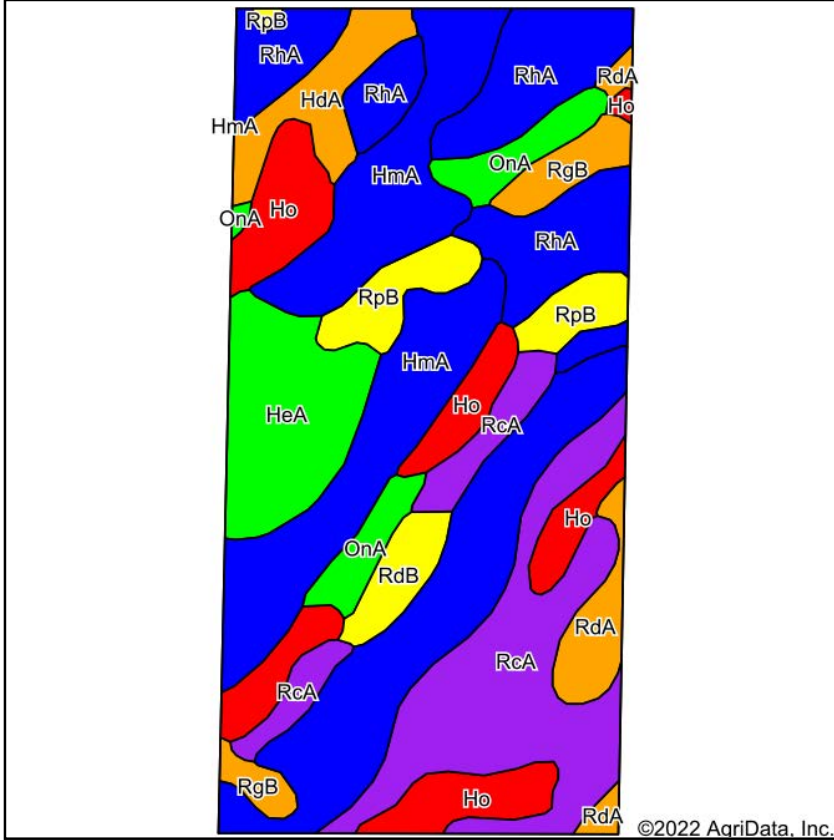

State: **South Dakota**  
 County: **Sully**  
 Location: **34-114N-76W**  
 Township: **East Sully**  
 Acres: **303.26**  
 Date: **7/5/2022**











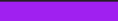

Maps Provided By:  
  
 CUSTOMIZED ONLINE MAPPING  
 © AgriData, Inc. 2021 www.AgriDataInc.com



Soils data provided by USDA and NRCS.

Area Symbol: SD119, Soil Area Version: 24

Code	Soil Description	Acres	Percent of field	PI Legend	Non-Irr Class *c	Productivity Index
HmA	Highmore-Walke silt loams, 0 to 2 percent slopes	90.62	29.9%		IIc	85
RcA	Raber-Cavo loams, 0 to 2 percent slopes	51.14	16.9%		IIc	60
RhA	Eakin-Raber complex, 0 to 2 percent slopes	42.32	14.0%		IIc	83
Ho	Hoven silt loam, 0 to 1 percent slopes	34.19	11.3%		VIIs	15
HeA	Highmore silt loam, 0 to 2 percent slopes	24.06	7.9%		IIc	92
RpB	Raber-Peno loams, 2 to 6 percent slopes	13.57	4.5%		IIe	65
OnA	Mobridge silt loam, 0 to 2 percent slopes	12.16	4.0%		IIc	94
HdA	Highmore-DeGrey silt loams, 0 to 2 percent slopes	11.06	3.6%		IIc	76
RdA	Raber-Demky loams, 0 to 2 percent slopes	9.14	3.0%		IIc	75
RgB	Eakin-Raber complex, 2 to 6 percent slopes	8.59	2.8%		IIe	76
RdB	Raber-Demky loams, 2 to 5 percent slopes	6.41	2.1%		IIe	66
<b>Weighted Average</b>					<b>2.45</b>	<b>71.3</b>

\*c: Using Capabilities Class Dominant Condition Aggregation Method  
 Soils data provided by USDA and NRCS.



# TRACT 6

## Soils Map

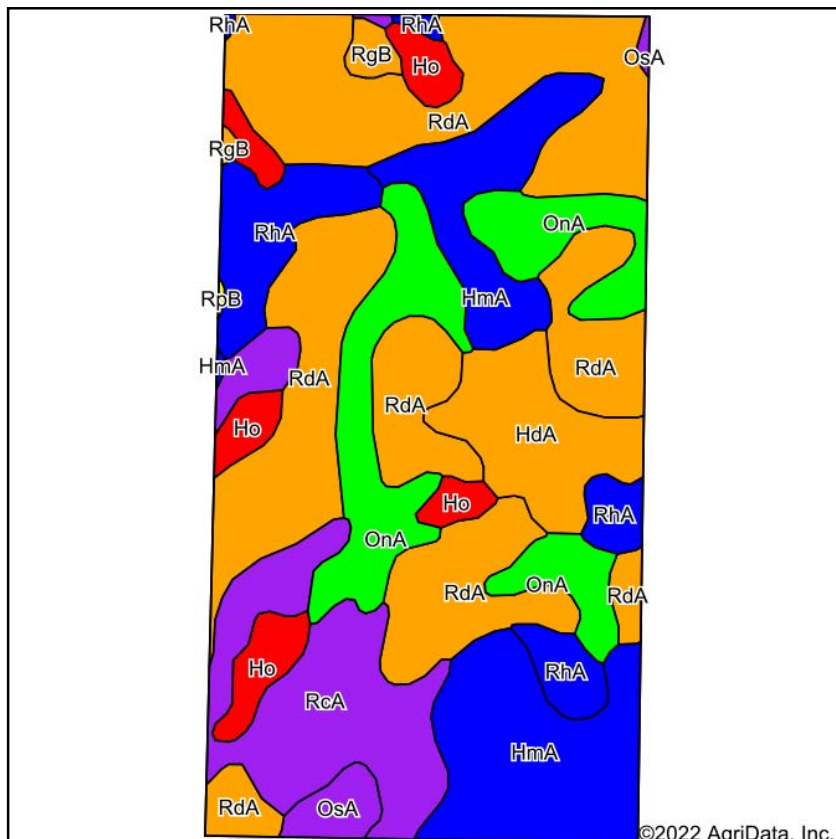

Soils data provided by USDA and NRCS.

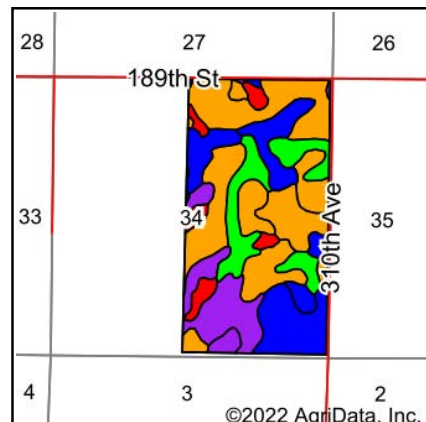

State: **South Dakota**  
 County: **Sully**  
 Location: **34-114N-76W**  
 Township: **East Sully**  
 Acres: **323.48**  
 Date: **7/5/2022**



Maps Provided By:



Area Symbol: SD119, Soil Area Version: 24

Code	Soil Description	Acres	Percent of field	PI Legend	Non-Irr Class *c	Productivity Index
RdA	Raber-Demky loams, 0 to 2 percent slopes	120.87	37.4%		IIc	75
HmA	Highmore-Walke silt loams, 0 to 2 percent slopes	51.73	16.0%		IIc	85
OnA	Mobridge silt loam, 0 to 2 percent slopes	41.98	13.0%		IIc	94
RcA	Raber-Cavo loams, 0 to 2 percent slopes	40.20	12.4%		IIc	60
RhA	Eakin-Raber complex, 0 to 2 percent slopes	23.16	7.2%		IIc	83
HdA	Highmore-DeGrey silt loams, 0 to 2 percent slopes	20.63	6.4%		IIc	76
Ho	Hoven silt loam, 0 to 1 percent slopes	16.72	5.2%		VIIs	15
OsA	Onita-Hoven silt loams, 0 to 1 percent slopes	5.41	1.7%		IIc	59
RgB	Eakin-Raber complex, 2 to 6 percent slopes	2.63	0.8%		Ile	76
RpB	Raber-Peno loams, 2 to 6 percent slopes	0.15	0.0%		Ile	65
Weighted Average					2.21	74.5

\*c: Using Capabilities Class Dominant Condition Aggregation Method  
 Soils data provided by USDA and NRCS.



United States  
Department of  
Agriculture

## Sully County, South Dakota

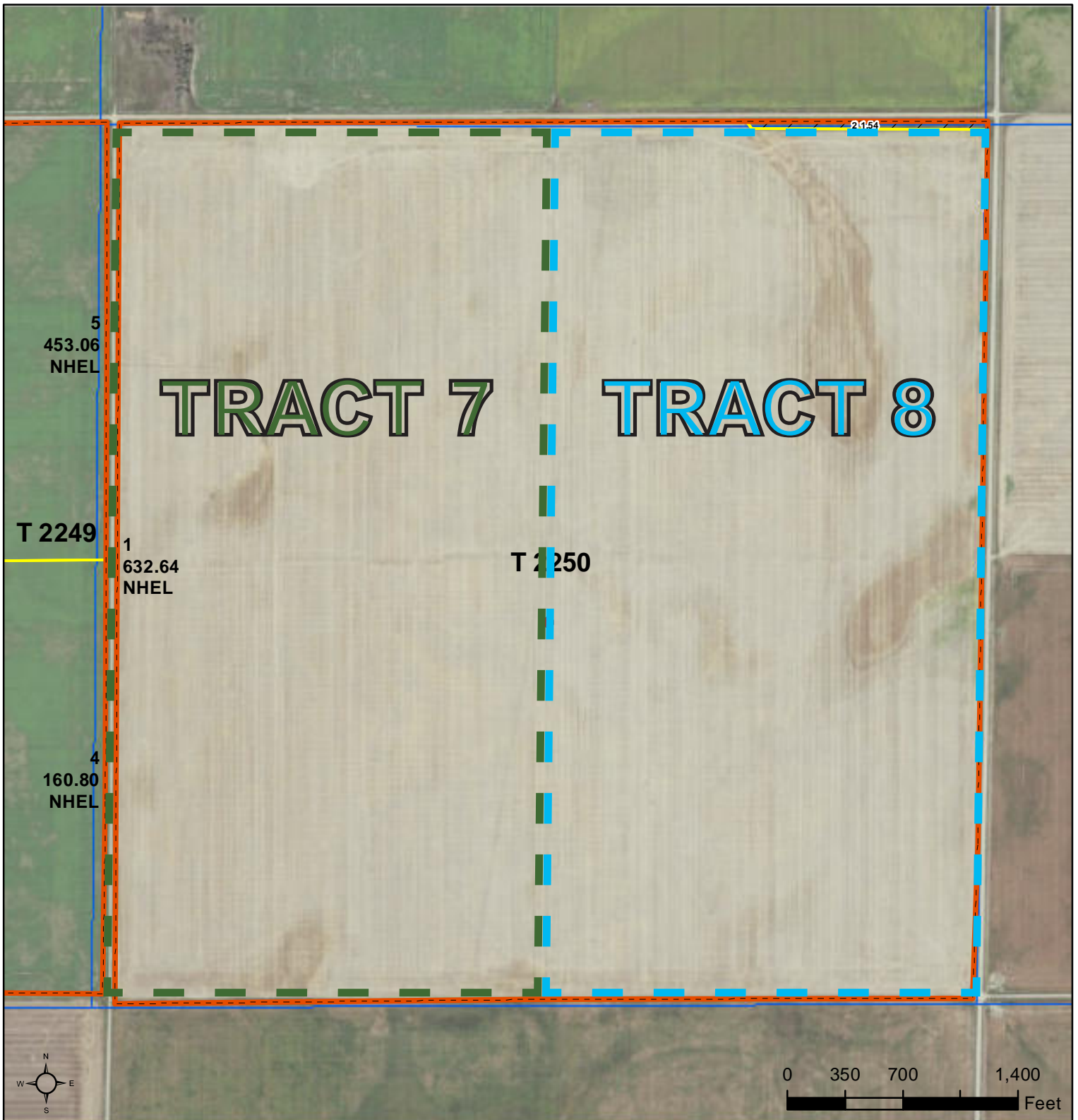

**Common Land Unit**

- Tract Boundary
- Non-Cropland
- PLSS
- Cropland

### Wetland Determination Identifiers

- Restricted Use
- Limited Restrictions
- Exempt from Conservation Compliance Provisions

2022 Program Year

Map Created May 03, 2022

Farm **5366**

**35-114N-76W-Sully**

United States Department of Agriculture (USDA) Farm Service Agency (FSA) maps are for FSA Program administration only. This map does not represent a legal survey or reflect actual ownership; rather it depicts the information provided directly from the producer and/or National Agricultural Imagery Program (NAIP) imagery. The producer accepts the data 'as is' and assumes all risks associated with its use. USDA-FSA assumes no responsibility for actual or consequential damage incurred as a result of any user's reliance on this data outside FSA Programs. Wetland identifiers do not represent the size, shape, or specific determination of the area. Refer to your original determination (CPA-026 and attached maps) for exact boundaries and determinations or contact USDA Natural Resources Conservation Service (NRCS).



# TRACT 7

## Soils Map

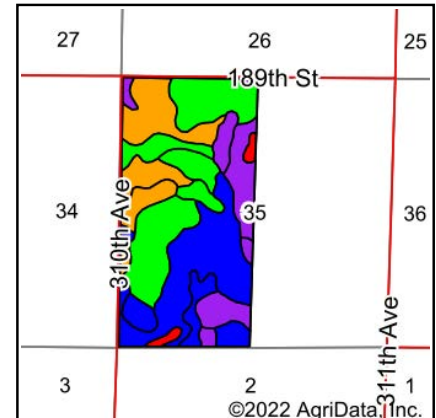
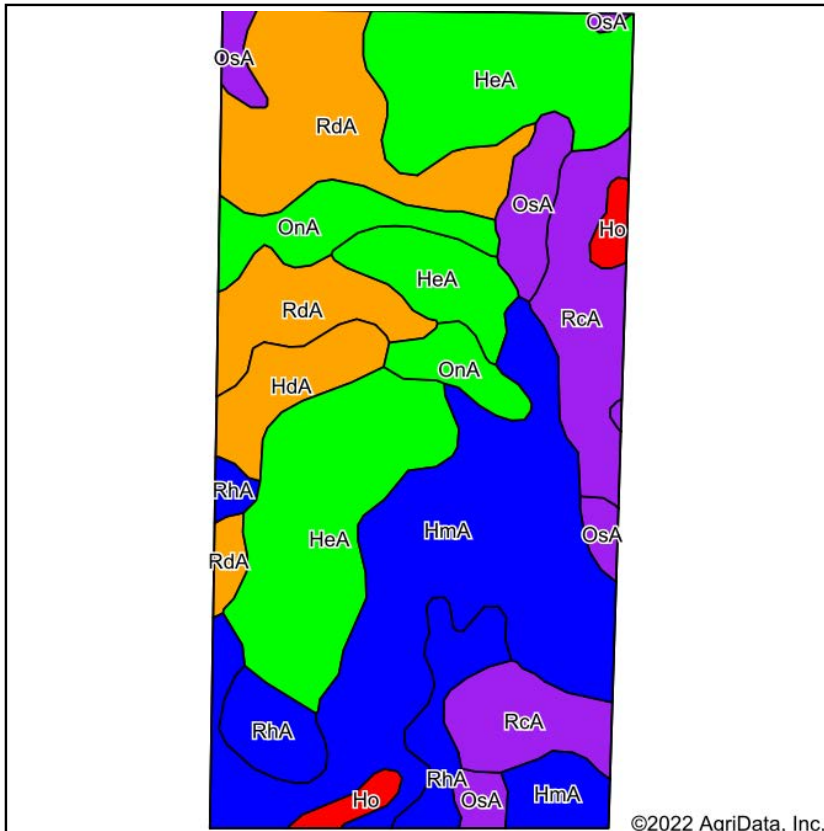

State: **South Dakota**  
 County: **Sully**  
 Location: **35-114N-76W**  
 Township: **East Sully**  
 Acres: **313.9**  
 Date: **7/5/2022**



Maps Provided By:  
**surety**  
 CUSTOMIZED ONLINE MAPPING  
 © AgriData, Inc. 2021 [www.AgriDataInc.com](http://www.AgriDataInc.com)



Soils data provided by USDA and NRCS.

Area Symbol: SD119, Soil Area Version: 24

Code	Soil Description	Acres	Percent of field	PI Legend	Non-Irr Class *c	Productivity Index
HeA	Highmore silt loam, 0 to 2 percent slopes	82.87	26.4%		IIc	92
HmA	Highmore-Walke silt loams, 0 to 2 percent slopes	79.59	25.4%		IIc	85
RdA	Raber-Demky loams, 0 to 2 percent slopes	48.39	15.4%		IIc	75
RcA	Raber-Cavo loams, 0 to 2 percent slopes	33.05	10.5%		IIc	60
RhA	Eakin-Raber complex, 0 to 2 percent slopes	19.43	6.2%		IIc	83
OnA	Mobridge silt loam, 0 to 2 percent slopes	18.55	5.9%		IIc	94
OsA	Onita-Hoven silt loams, 0 to 1 percent slopes	15.93	5.1%		IIc	59
HdA	Highmore-DeGrey silt loams, 0 to 2 percent slopes	11.15	3.6%		IIc	76
Ho	Hoven silt loam, 0 to 1 percent slopes	4.94	1.6%		Vis	15
Weighted Average					2.06	80.3

\*c: Using Capabilities Class Dominant Condition Aggregation Method  
 Soils data provided by USDA and NRCS.

# TRACT 8

## Soils Map

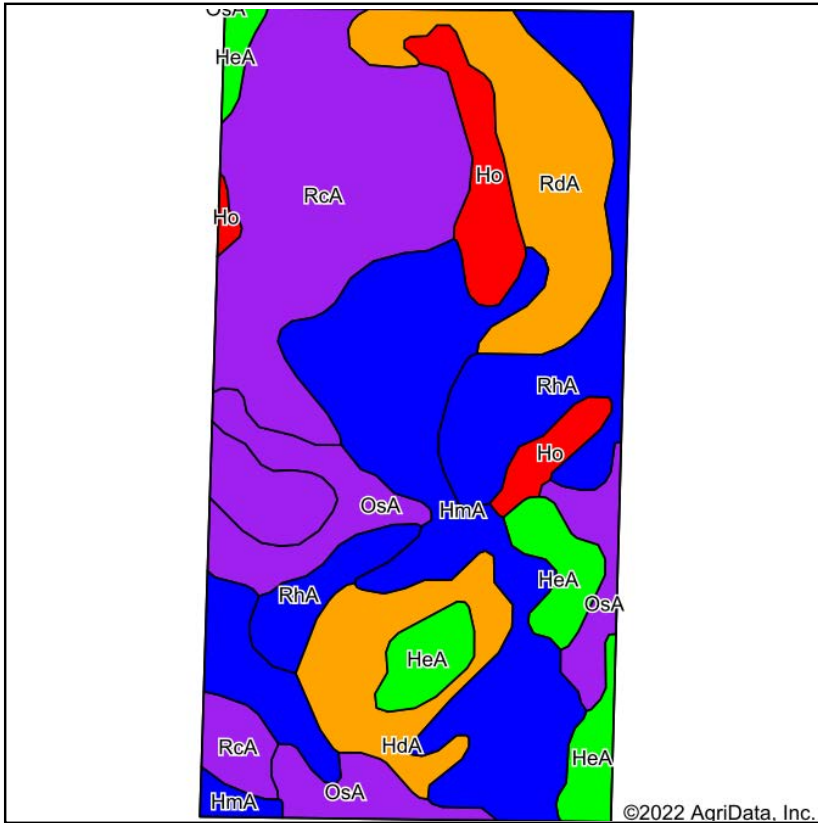

Soils data provided by USDA and NRCS.

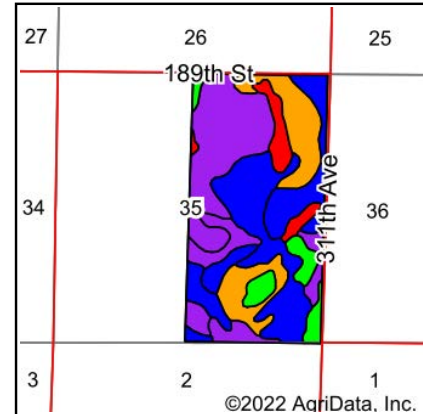

State: **South Dakota**  
 County: **Sully**  
 Location: **35-114N-76W**  
 Township: **East Sully**  
 Acres: **320.1**  
 Date: **7/5/2022**



Maps Provided By:



Area Symbol: SD119, Soil Area Version: 24

Code	Soil Description	Acres	Percent of field	PI Legend	Non-Irr Class *c	Productivity Index
RcA	Raber-Cavo loams, 0 to 2 percent slopes	78.23	24.4%		IIc	60
HmA	Highmore-Walke silt loams, 0 to 2 percent slopes	74.92	23.4%		IIc	85
RhA	Eakin-Raber complex, 0 to 2 percent slopes	39.37	12.3%		IIc	83
RdA	Raber-Demky loams, 0 to 2 percent slopes	33.24	10.4%		IIc	75
OsA	Onita-Hoven silt loams, 0 to 1 percent slopes	31.57	9.9%		IIc	59
HeA	Highmore silt loam, 0 to 2 percent slopes	22.46	7.0%		IIc	92
HdA	Highmore-DeGrey silt loams, 0 to 2 percent slopes	22.24	6.9%		IIc	76
Ho	Hoven silt loam, 0 to 1 percent slopes	18.07	5.6%		VIIs	15
Weighted Average					2.23	71

\*c: Using Capabilities Class Dominant Condition Aggregation Method  
 Soils data provided by USDA and NRCS.





United States  
Department of  
Agriculture

## Sully County, South Dakota

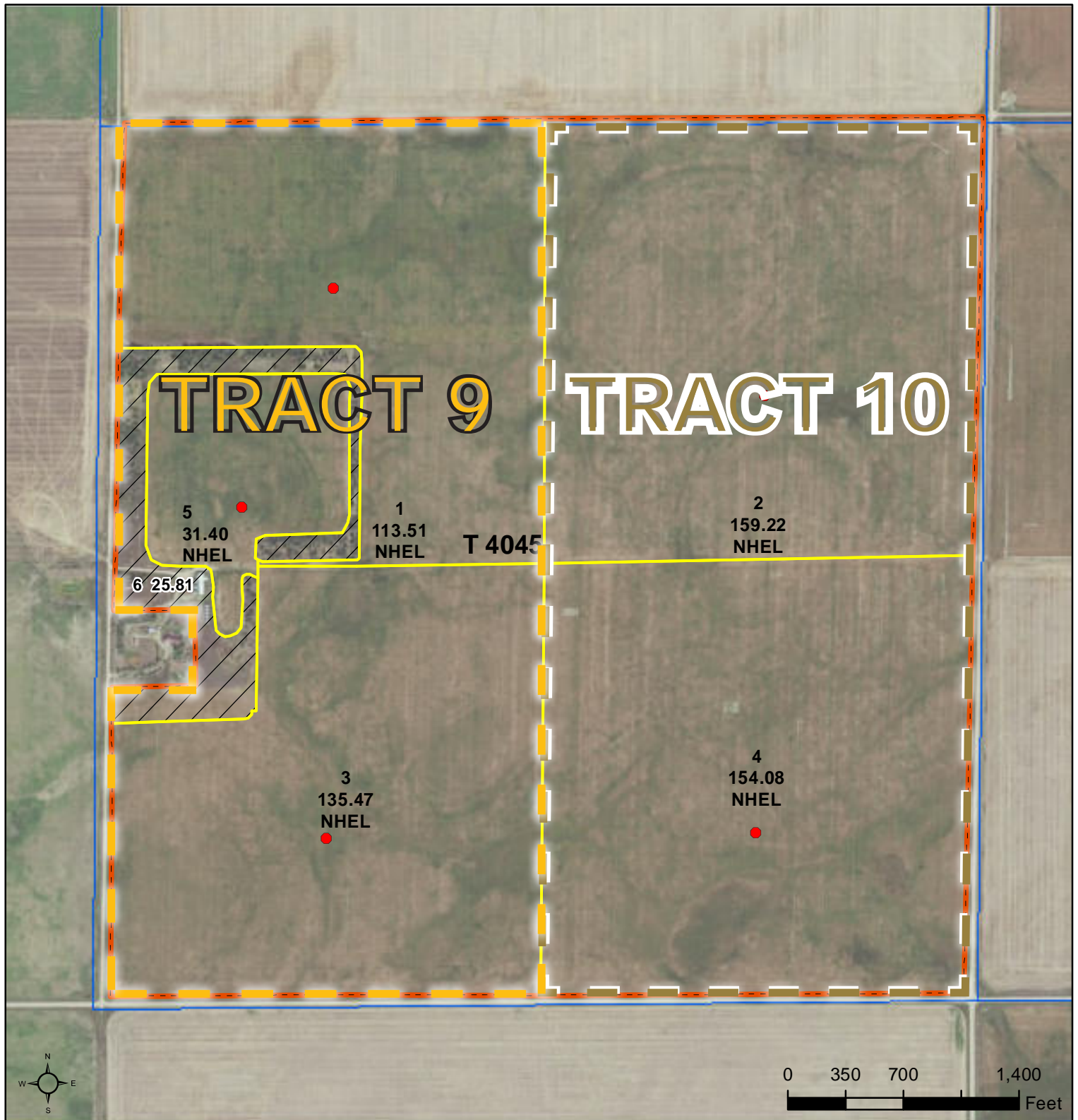

**Common Land Unit**

Non-Cropland	Tract Boundary
Cropland	PLSS

### Wetland Determination Identifiers

- Restricted Use
- Limited Restrictions
- Exempt from Conservation
- Compliance Provisions

United States Department of Agriculture (USDA) Farm Service Agency (FSA) maps are for FSA Program administration only. This map does not represent a legal survey or reflect actual ownership; rather it depicts the information provided directly from the producer and/or National Agricultural Imagery Program (NAIP) imagery. The producer accepts the data 'as is' and assumes all risks associated with its use. USDA-FSA assumes no responsibility for actual or consequential damage incurred as a result of any user's reliance on this data outside FSA Programs. Wetland identifiers do not represent the size, shape, or specific determination of the area. Refer to your original determination (CPA-026 and attached maps) for exact boundaries and determinations or contact USDA Natural Resources Conservation Service (NRCS).

2022 Program Year

Map Created June 16, 2022

Farm **5397**

**2-113N-76W-Sully**

# TRACT 9

## Soils Map

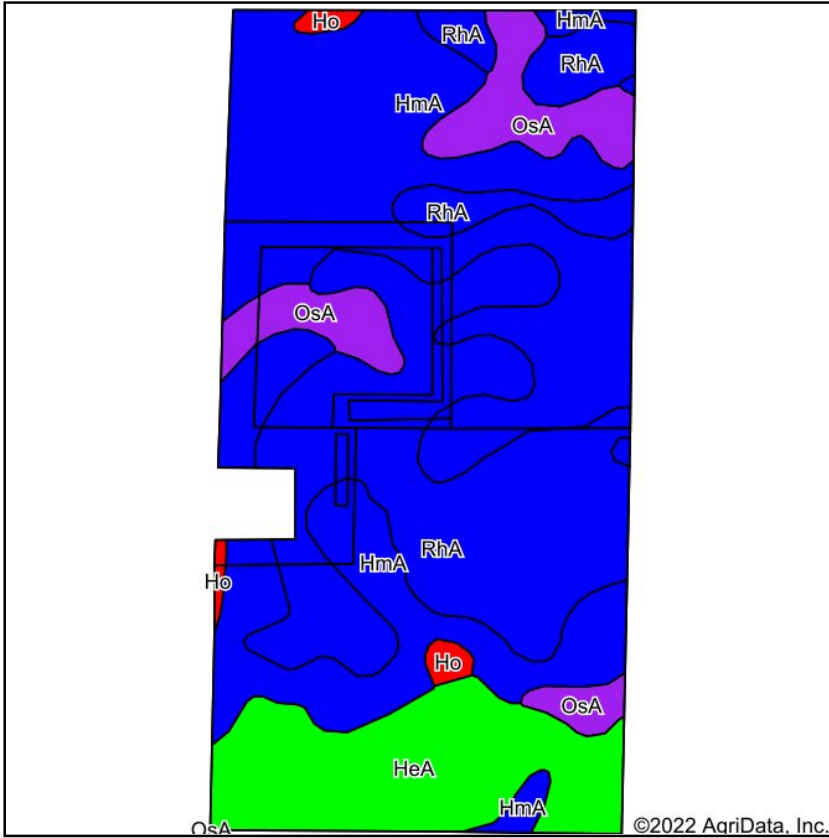

Soils data provided by USDA and NRCS.

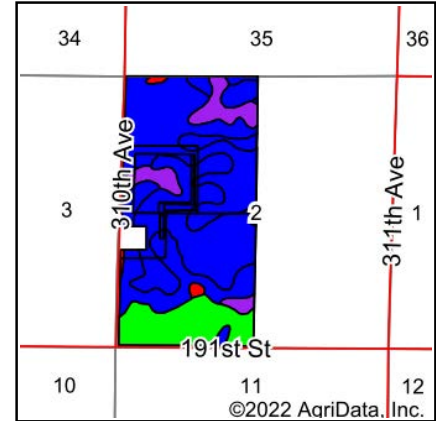

State: **South Dakota**  
 County: **Sully**  
 Location: **2-113N-76W**  
 Township: **East Sully**  
 Acres: **306.18**  
 Date: **7/5/2022**



Maps Provided By:



© AgriData, Inc. 2021

www.AgriDataInc.com



Area Symbol: SD119, Soil Area Version: 24

Code	Soil Description	Acres	Percent of field	PI Legend	Non-Irr Class *c	Productivity Index
HmA	Highmore-Walke silt loams, 0 to 2 percent slopes	132.86	43.4%		IIc	85
RhA	Eakin-Raber complex, 0 to 2 percent slopes	99.49	32.5%		IIc	83
HeA	Highmore silt loam, 0 to 2 percent slopes	44.15	14.4%		IIc	92
OsA	Onita-Hoven silt loams, 0 to 1 percent slopes	26.29	8.6%		IIc	59
Ho	Hoven silt loam, 0 to 1 percent slopes	3.39	1.1%		VIIs	15
<b>Weighted Average</b>					<b>2.04</b>	<b>82.4</b>

\*c: Using Capabilities Class Dominant Condition Aggregation Method  
 Soils data provided by USDA and NRCS.



# TRACT 10

## Soils Map

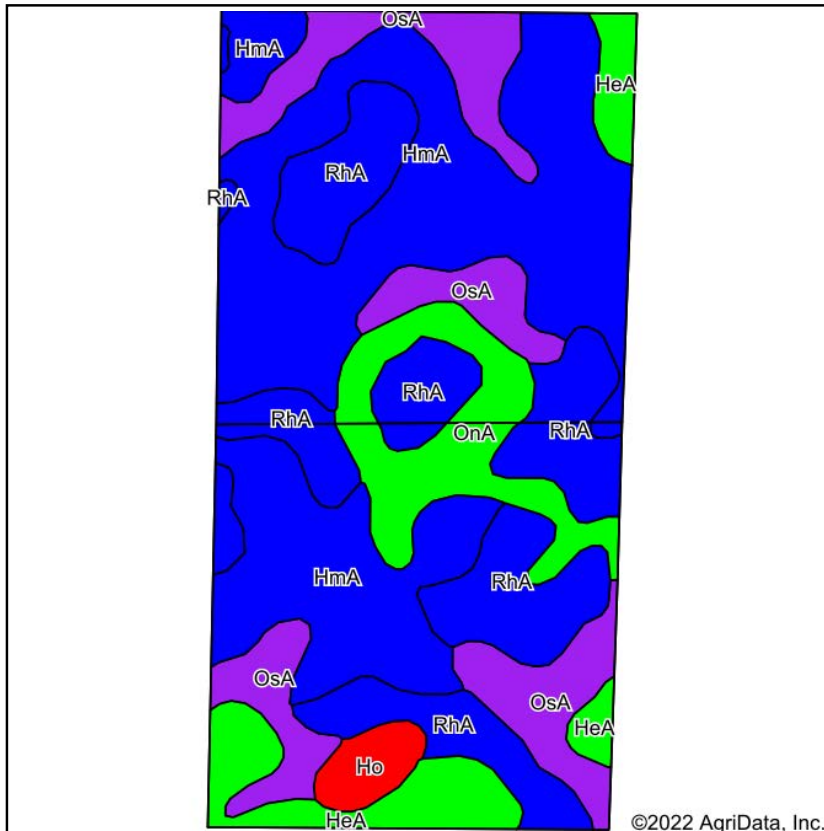

Soils data provided by USDA and NRCS.

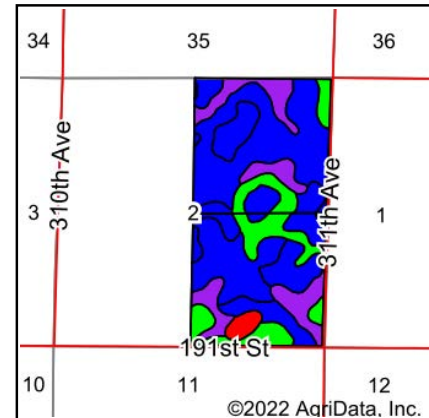

State: **South Dakota**  
 County: **Sully**  
 Location: **2-113N-76W**  
 Township: **East Sully**  
 Acres: **313.3**  
 Date: **7/5/2022**



Maps Provided By:  
  
 CUSTOMIZED ONLINE MAPPING  
 © AgriData, Inc. 2021 www.AgriDataInc.com



Area Symbol: SD119, Soil Area Version: 24

Code	Soil Description	Acres	Percent of field	PI Legend	Non-Irr Class *c	Productivity Index
HmA	Highmore-Walke silt loams, 0 to 2 percent slopes	127.88	40.8%		IIc	85
RhA	Eakin-Raber complex, 0 to 2 percent slopes	76.93	24.6%		IIc	83
OsA	Onita-Hoven silt loams, 0 to 1 percent slopes	50.30	16.1%		IIc	59
OnA	Mobridge silt loam, 0 to 2 percent slopes	27.84	8.9%		IIc	94
HeA	Highmore silt loam, 0 to 2 percent slopes	23.98	7.7%		IIc	92
Ho	Hoven silt loam, 0 to 1 percent slopes	6.37	2.0%		VIIs	15
Weighted Average					2.08	80.2

\*c: Using Capabilities Class Dominant Condition Aggregation Method  
 Soils data provided by USDA and NRCS.



United States  
Department of  
Agriculture

## Sully County, South Dakota

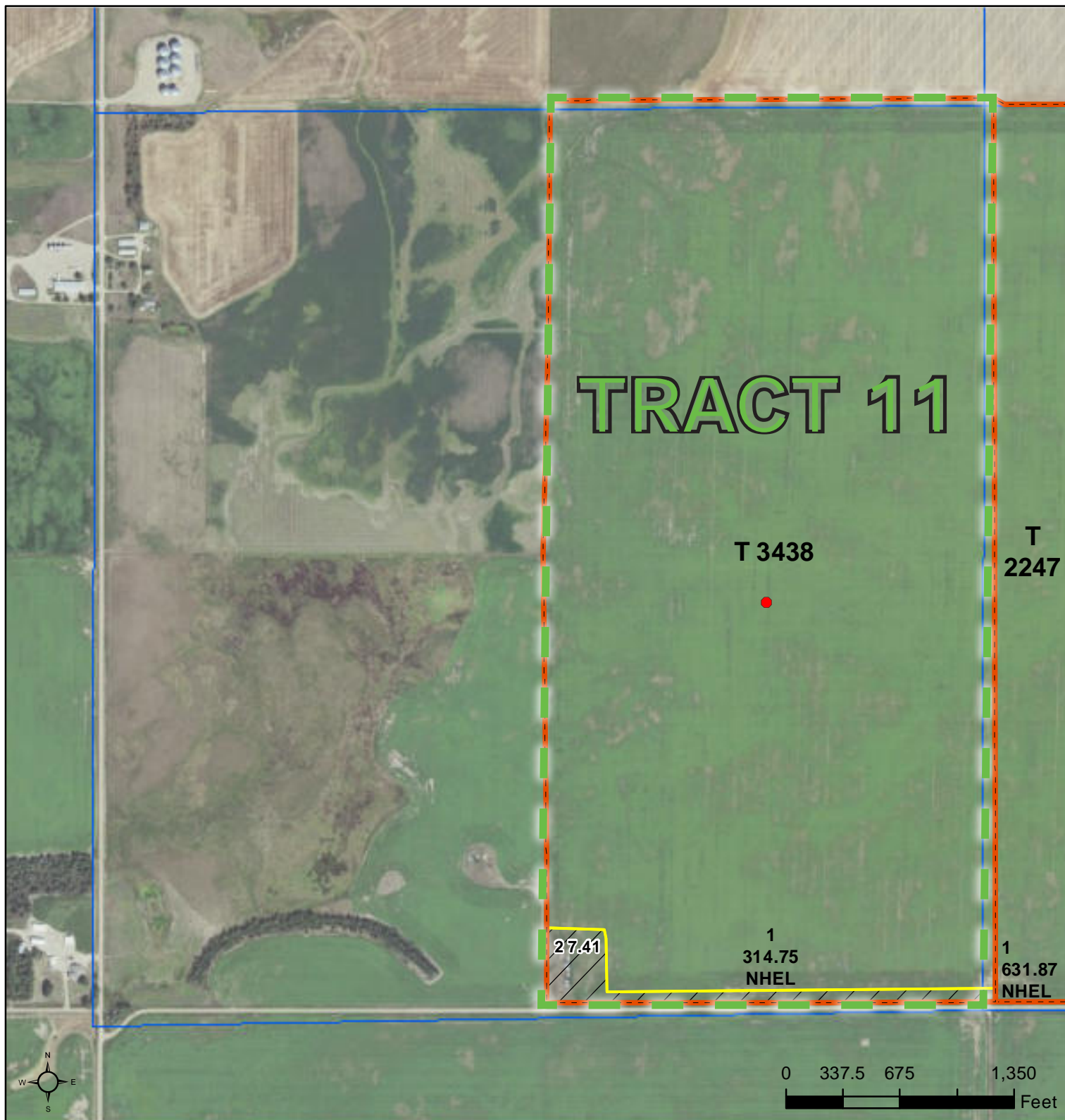

### Common Land Unit

- Non-Cropland
- Cropland

- Tract Boundary
- PLSS

### Wetland Determination Identifiers

- Restricted Use
- Limited Restrictions
- Exempt from Conservation
- Compliance Provisions

2022 Program Year

Map Created June 16, 2022

Farm **5397**

**28-114N-76W-Sully**

United States Department of Agriculture (USDA) Farm Service Agency (FSA) maps are for FSA Program administration only. This map does not represent a legal survey or reflect actual ownership; rather it depicts the information provided directly from the producer and/or National Agricultural Imagery Program (NAIP) imagery. The producer accepts the data 'as is' and assumes all risks associated with its use. USDA-FSA assumes no responsibility for actual or consequential damage incurred as a result of any user's reliance on this data outside FSA Programs. Wetland identifiers do not represent the size, shape, or specific determination of the area. Refer to your original determination (CPA-026 and attached maps) for exact boundaries and determinations or contact USDA Natural Resources Conservation Service (NRCS).



# TRACT 11

## Soils Map

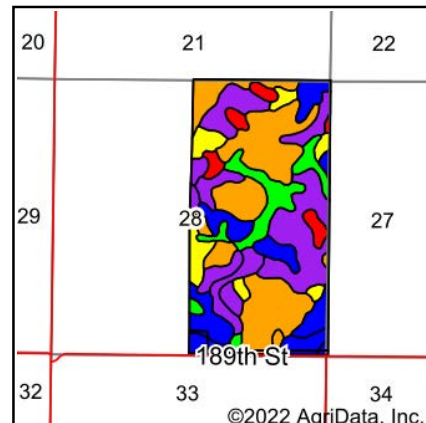
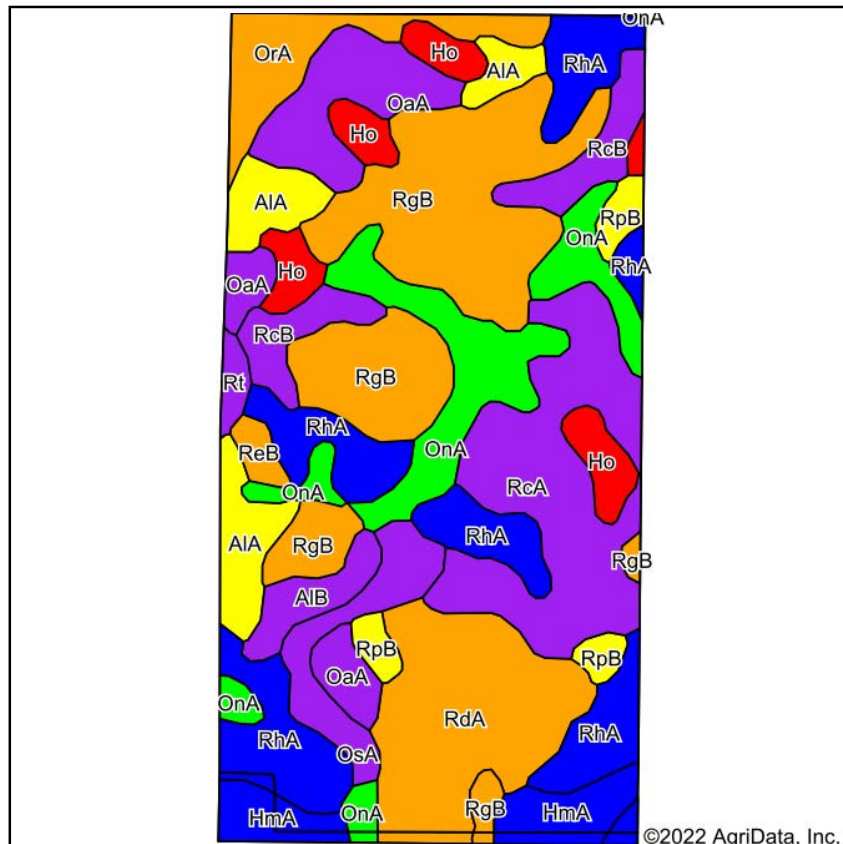

State: **South Dakota**  
 County: **Sully**  
 Location: **28-114N-76W**  
 Township: **East Sully**  
 Acres: **322.16**  
 Date: **7/5/2022**



Maps Provided By

**surety**  
 CUSTOMIZED ONLINE MAPPING  
 © AgriData, Inc. 2021 www.AgriDataInc.com



Soils data provided by USDA and NRCS.

Area Symbol: SD119, Soil Area Version: 24

Code	Soil Description	Acres	Percent of field	PI Legend	Non-Irr Class *c	Productivity Index
RgB	Eakin-Raber complex, 2 to 6 percent slopes	57.47	17.8%		Ile	76
RhA	Eakin-Raber complex, 0 to 2 percent slopes	43.62	13.5%		Ilc	83
RcA	Raber-Cavo loams, 0 to 2 percent slopes	38.67	12.0%		Ilc	60
RdA	Raber-Demky loams, 0 to 2 percent slopes	33.09	10.3%		Ilc	75
OnA	Mobridge silt loam, 0 to 2 percent slopes	30.22	9.4%		Ilc	94
OaA	Oahe-Delmont loams, 0 to 2 percent slopes	21.53	6.7%		IIIs	52
AIA	Akaska silt loam, 0 to 2 percent slopes	16.94	5.3%		IIIs	66
Ho	Hoven silt loam, 0 to 1 percent slopes	14.10	4.4%		VIIs	15
RcB	Raber-Cavo loams, 2 to 6 percent slopes	13.53	4.2%		Ile	57
OrA	Onita-DeGrey silt loams, 0 to 2 percent slopes	12.95	4.0%		Ilc	76
HmA	Highmore-Walke silt loams, 0 to 2 percent slopes	12.28	3.8%		Ilc	85
OsA	Onita-Hoven silt loams, 0 to 1 percent slopes	11.09	3.4%		Ilc	59
RpB	Raber-Peno loams, 2 to 6 percent slopes	6.31	2.0%		Ile	65
AIB	Akaska silt loam, 2 to 5 percent slopes	5.96	1.9%		IIIs	58
ReB	Ree loam, 2 to 5 percent slopes	2.30	0.7%		Ile	80
Rt	Ree and Durrstein soils	2.10	0.7%		Ilc	58
Weighted Average					2.31	70.1

\*c: Using Capabilities Class Dominant Condition Aggregation Method  
 Soils data provided by USDA and NRCS.



United States  
Department of  
Agriculture

## Sully County, South Dakota

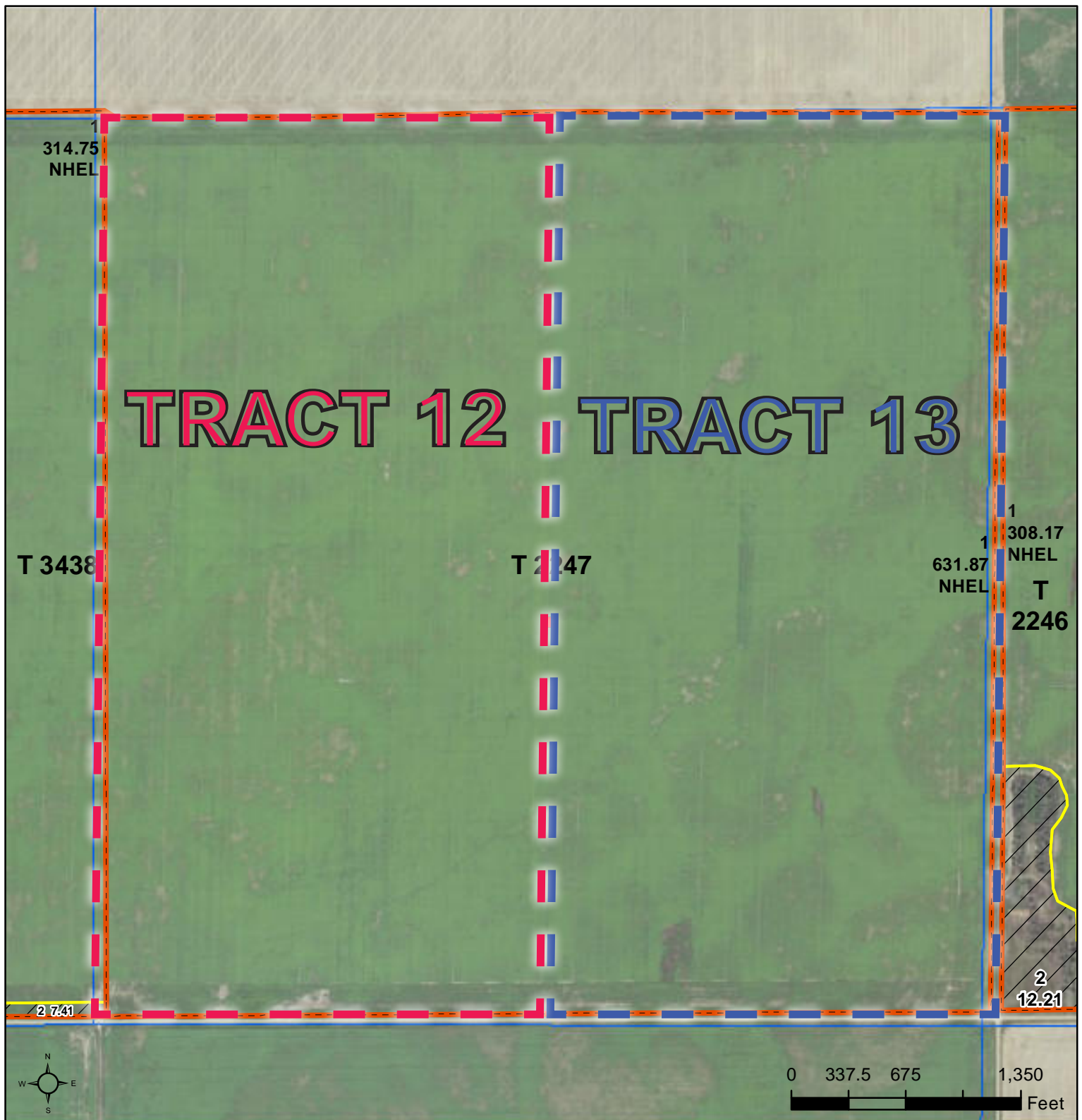

**Common Land Unit**

	Tract Boundary
	PLSS
	Non-Cropland
	Cropland

### Wetland Determination Identifiers

- Restricted Use
- Limited Restrictions
- Exempt from Conservation
- Compliance Provisions

2022 Program Year

Map Created June 16, 2022

Farm **5397**

**27-114N-76W-Sully**

United States Department of Agriculture (USDA) Farm Service Agency (FSA) maps are for FSA Program administration only. This map does not represent a legal survey or reflect actual ownership; rather it depicts the information provided directly from the producer and/or National Agricultural Imagery Program (NAIP) imagery. The producer accepts the data 'as is' and assumes all risks associated with its use. USDA-FSA assumes no responsibility for actual or consequential damage incurred as a result of any user's reliance on this data outside FSA Programs. Wetland identifiers do not represent the size, shape, or specific determination of the area. Refer to your original determination (CPA-026 and attached maps) for exact boundaries and determinations or contact USDA Natural Resources Conservation Service (NRCS).



# TRACT 12

## Soils Map

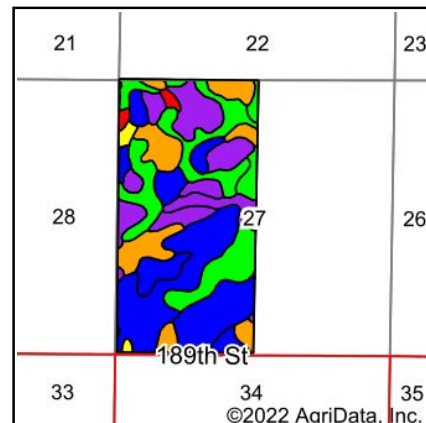
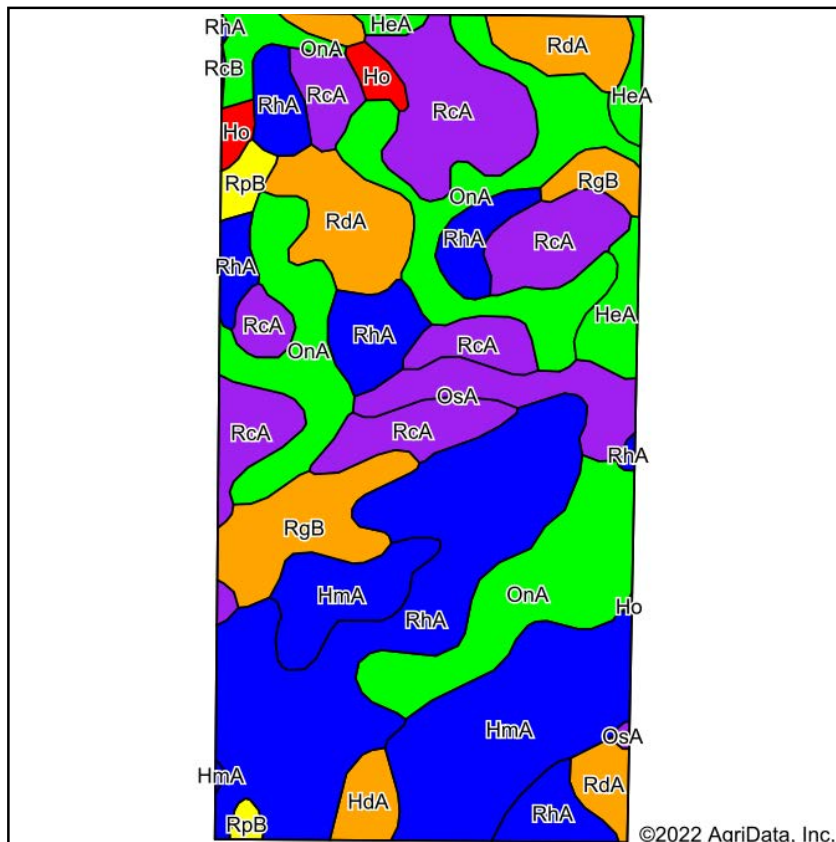

State: **South Dakota**  
 County: **Sully**  
 Location: **27-114N-76W**  
 Township: **East Sully**  
 Acres: **320.04**  
 Date: **7/5/2022**



Maps Provided By:



Soils data provided by USDA and NRCS.

Area Symbol: SD119, Soil Area Version: 24

Code	Soil Description	Acres	Percent of field	PI Legend	Non-Irr Class *c	Productivity Index
RhA	Eakin-Raber complex, 0 to 2 percent slopes	79.82	24.9%		IIc	83
OnA	Mobridge silt loam, 0 to 2 percent slopes	70.16	21.9%		IIc	94
RcA	Raber-Cavo loams, 0 to 2 percent slopes	53.65	16.8%		IIc	60
HmA	Highmore-Walke silt loams, 0 to 2 percent slopes	41.61	13.0%		IIc	85
RdA	Raber-Demky loams, 0 to 2 percent slopes	23.81	7.4%		IIc	75
RgB	Eakin-Raber complex, 2 to 6 percent slopes	18.94	5.9%		Ile	76
OsA	Onita-Hoven silt loams, 0 to 1 percent slopes	11.30	3.5%		IIc	59
HeA	Highmore silt loam, 0 to 2 percent slopes	8.89	2.8%		IIc	92
HdA	Highmore-DeGrey silt loams, 0 to 2 percent slopes	4.37	1.4%		IIc	76
Ho	Hoven silt loam, 0 to 1 percent slopes	3.84	1.2%		VIIs	15
RpB	Raber-Peno loams, 2 to 6 percent slopes	3.53	1.1%		Ile	65
RcB	Raber-Cavo loams, 2 to 6 percent slopes	0.12	0.0%		Ile	57
Weighted Average					2.05	79.1

\*c: Using Capabilities Class Dominant Condition Aggregation Method  
 Soils data provided by USDA and NRCS.

# TRACT 13

## Soils Map

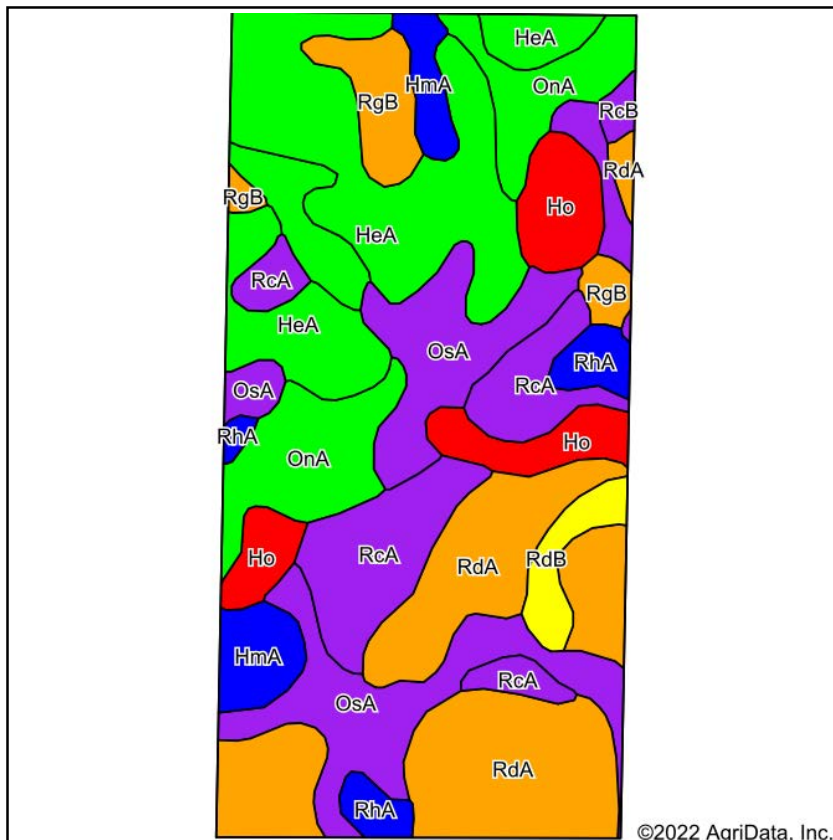

©2022 AgriData, Inc.

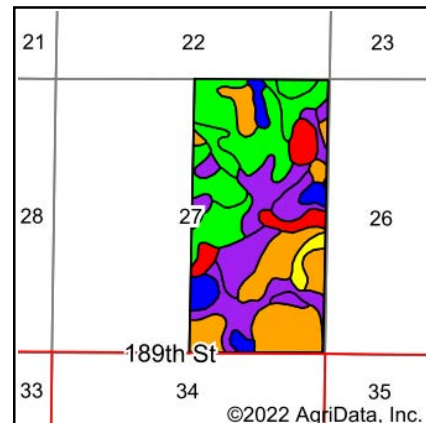

State: **South Dakota**  
 County: **Sully**  
 Location: **27-114N-76W**  
 Township: **East Sully**  
 Acres: **313.87**  
 Date: **7/5/2022**



Maps Provided By:



Soils data provided by USDA and NRCS.

Area Symbol: SD119, Soil Area Version: 24

Code	Soil Description	Acres	Percent of field	PI Legend	Non-Irr Class *c	Productivity Index
RdA	Raber-Demky loams, 0 to 2 percent slopes	66.33	21.1%		IIc	75
HeA	Highmore silt loam, 0 to 2 percent slopes	60.77	19.4%		IIc	92
OsA	Onita-Hoven silt loams, 0 to 1 percent slopes	47.53	15.1%		IIc	59
RcA	Raber-Cavo loams, 0 to 2 percent slopes	37.86	12.1%		IIc	60
OnA	Mobridge silt loam, 0 to 2 percent slopes	37.58	12.0%		IIc	94
Ho	Hoven silt loam, 0 to 1 percent slopes	22.54	7.2%		VIIs	15
RgB	Eakin-Raber complex, 2 to 6 percent slopes	12.90	4.1%		IIe	76
HmA	Highmore-Walke silt loams, 0 to 2 percent slopes	12.07	3.8%		IIc	85
RhA	Eakin-Raber complex, 0 to 2 percent slopes	8.15	2.6%		IIc	83
RdB	Raber-Demky loams, 2 to 5 percent slopes	6.47	2.1%		IIe	66
RcB	Raber-Cavo loams, 2 to 6 percent slopes	1.67	0.5%		IIe	57
Weighted Average					2.29	72.4

\*c: Using Capabilities Class Dominant Condition Aggregation Method  
 Soils data provided by USDA and NRCS.





United States  
Department of  
Agriculture

## Sully County, South Dakota

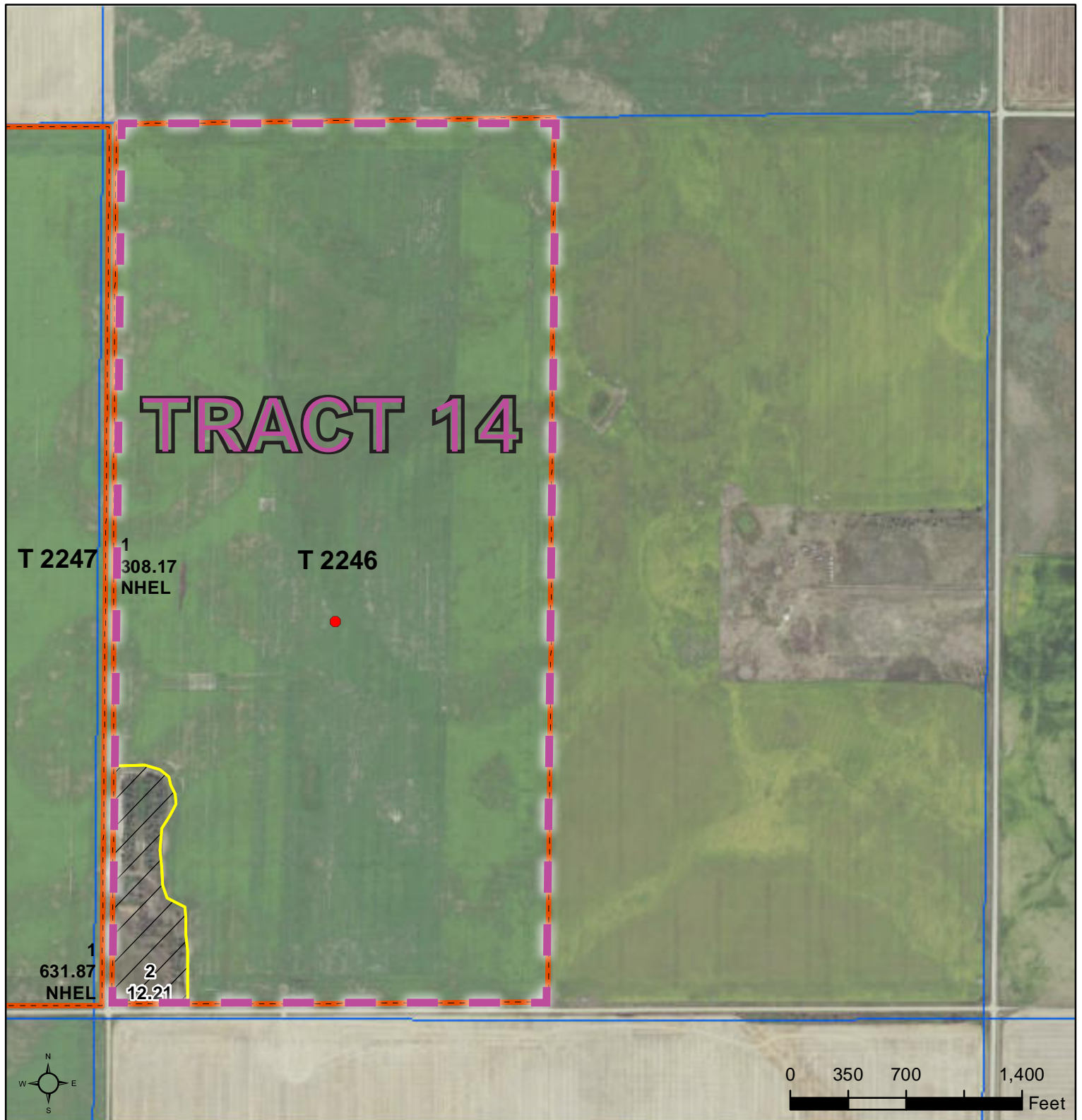





**Common Land Unit**  Tract Boundary

 Non-Cropland

 Cropland

 PLSS

### Wetland Determination Identifiers

-  Restricted Use
-  Limited Restrictions
-  Exempt from Conservation
-  Compliance Provisions

**2022 Program Year**

Map Created June 16, 2022

**Farm 5397**

**26-114N-76W-Sully**

United States Department of Agriculture (USDA) Farm Service Agency (FSA) maps are for FSA Program administration only. This map does not represent a legal survey or reflect actual ownership; rather it depicts the information provided directly from the producer and/or National Agricultural Imagery Program (NAIP) imagery. The producer accepts the data 'as is' and assumes all risks associated with its use. USDA-FSA assumes no responsibility for actual or consequential damage incurred as a result of any user's reliance on this data outside FSA Programs. Wetland identifiers do not represent the size, shape, or specific determination of the area. Refer to your original determination (CPA-026 and attached maps) for exact boundaries and determinations or contact USDA Natural Resources Conservation Service (NRCS).

# TRACT 14

## Soils Map

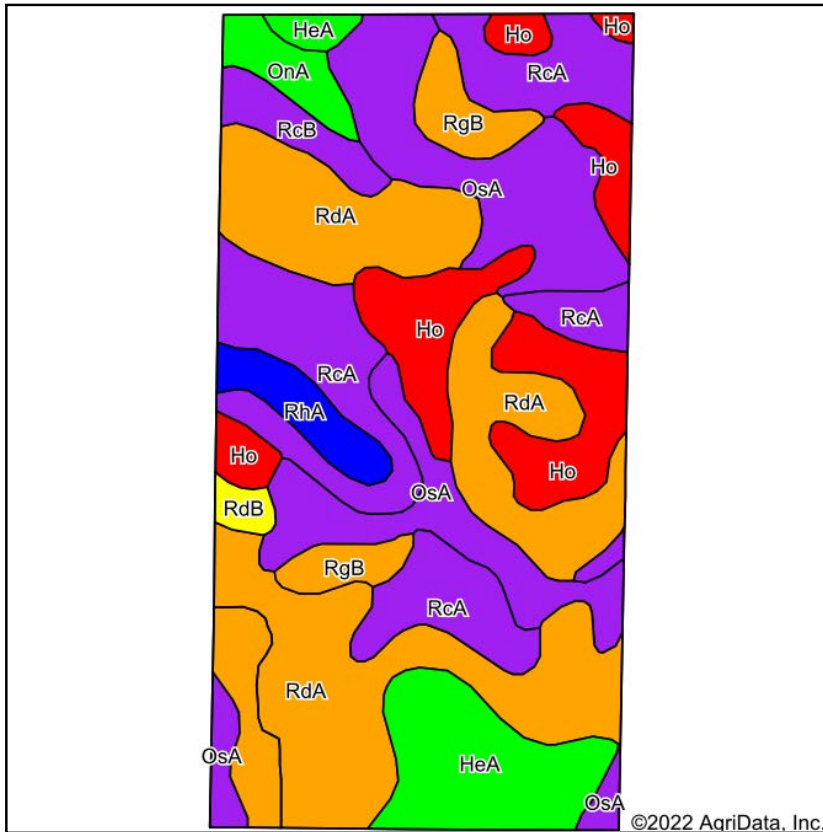

Soils data provided by USDA and NRCS.

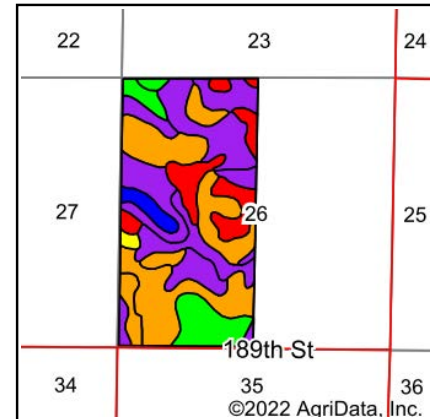

State: **South Dakota**

County: **Sully**

Location: **26-114N-76W**

Township: **East Sully**

Acres: **320.38**

Date: **7/5/2022**



Maps Provided By:



© AgriData, Inc. 2021

www.AgriDataInc.com



Area Symbol: SD119, Soil Area Version: 24

Code	Soil Description	Acres	Percent of field	PI Legend	Non-Irr Class *c	Productivity Index
RdA	Raber-Demky loams, 0 to 2 percent slopes	101.59	31.7%		IIc	75
OsA	Onita-Hoven silt loams, 0 to 1 percent slopes	57.98	18.1%		IIc	59
RcA	Raber-Cavo loams, 0 to 2 percent slopes	55.70	17.4%		IIc	60
Ho	Hoven silt loam, 0 to 1 percent slopes	40.19	12.5%		VIIs	15
HeA	Highmore silt loam, 0 to 2 percent slopes	27.17	8.5%		IIc	92
RgB	Eakin-Raber complex, 2 to 6 percent slopes	12.23	3.8%		Ile	76
RhA	Eakin-Raber complex, 0 to 2 percent slopes	8.59	2.7%		IIc	83
RcB	Raber-Cavo loams, 2 to 6 percent slopes	7.32	2.3%		Ile	57
OnA	Mobridge silt loam, 0 to 2 percent slopes	7.09	2.2%		IIc	94
RdB	Raber-Demky loams, 2 to 5 percent slopes	2.52	0.8%		Ile	66
Weighted Average					2.50	63.6

\*c: Using Capabilities Class Dominant Condition Aggregation Method  
Soils data provided by USDA and NRCS.



SOUTH DAKOTA

SULLY

Form: FSA-156EZ

See Page 4 for non-discriminatory Statements.

 United States Department of Agriculture  
 Farm Service Agency

## Abbreviated 156 Farm Record

FARM : 5366

Prepared : 6/22/22 3:48 PM

Crop Year : 2022

Operator Name :  
 Farms Associated with Operator :  
 CRP Contract Number(s) : None  
 Recon ID : 46-119-2022-94  
 Transferred From : None  
 ARCPLC G/I/F Eligibility : Eligible

## Farm Land Data

Farmland	Cropland	DCP Cropland	WBP	WRP	CRP	GRP	Sugarcane	Farm Status	Number Of Tracts
2,497.83	2,487.64	2,487.64	0.00	0.00	0.00	0.00	0.00	Active	4
State Conservation	Other Conservation	Effective DCP Cropland	Double Cropped		MPL	Acre Election	EWP	DCP Ag.Rel. Activity	Broken From Native Sod
0.00	0.00	2,487.64	0.00		0.00		0.00	0.00	0.00

## Crop Election Choice

ARC Individual	ARC County	Price Loss Coverage
None	WHEAT, CORN, SNFLR, SOYBN	None

## DCP Crop Data

Crop Name	Base Acres	CCC-505 CRP Reduction Acres	PLC Yield	HIP
Wheat	1254.18	0.00	44	
Corn	393.61	0.00	94	0
Sunflowers	287.24	0.00	2014	
Soybeans	463.89	0.00	28	0

TOTAL 2398.92 0.00

## NOTES

--

Tract Number : 2245

Description : 5-113-76  
 FSA Physical Location : SOUTH DAKOTA/SULLY  
 ANSI Physical Location : SOUTH DAKOTA/SULLY  
 BIA Unit Range Number :  
 HEL Status : NHEL: No agricultural commodity planted on undetermined fields  
 Wetland Status : Tract contains a wetland or farmed wetland  
 WL Violations : None  
 Owners : DEAN A NELSON FARMS INC  
 Other Producers :  
 Recon ID : None

## Tract Land Data

Farm Land	Cropland	DCP Cropland	WBP	WRP	CRP	GRP	Sugarcane
616.07	616.07	616.07	0.00	0.00	0.00	0.00	0.00
State Conservation	Other Conservation	Effective DCP Cropland	Double Cropped	MPL	EWP	DCP Ag. Rel Activity	Broken From Native Sod
0.00	0.00	616.07	0.00	0.00	0.00	0.00	0.00

SOUTH DAKOTA  
SULLY  
Form: FSA-156EZ



United States Department of Agriculture  
Farm Service Agency

Abbreviated 156 Farm Record

FARM : 5366  
Prepared : 6/22/22 3:48 PM  
Crop Year : 2022

DCP Crop Data

Tract 2245 Continued ...

Crop Name	Base Acres	CCC-505 CRP Reduction Acres	PLC Yield
Wheat	324.36	0.00	40
Corn	106.37	0.00	81
Soybeans	108.97	0.00	26
<b>TOTAL</b>	<b>539.70</b>	<b>0.00</b>	

NOTES

Tract Number : 2248

Description : 33-114-76  
FSA Physical Location : SOUTH DAKOTA/SULLY  
ANSI Physical Location : SOUTH DAKOTA/SULLY  
BIA Unit Range Number :  
HEL Status : NHEL: No agricultural commodity planted on undetermined fields  
Wetland Status : Tract contains a wetland or farmed wetland  
WL Violations : None  
Owners : DEAN A NELSON FARMS INC  
Other Producers :  
Recon ID : None

Tract Land Data

Farm Land	Cropland	DCP Cropland	WBP	WRP	CRP	GRP	Sugarcane
622.07	622.07	622.07	0.00	0.00	0.00	0.00	0.00
State Conservation	Other Conservation	Effective DCP Cropland	Double Cropped	MPL	EWP	DCP Ag. Rel Activity	Broken From Native Sod
0.00	0.00	622.07	0.00	0.00	0.00	0.00	0.00

DCP Crop Data

Crop Name	Base Acres	CCC-505 CRP Reduction Acres	PLC Yield
Wheat	309.00	0.00	46
Corn	95.46	0.00	99
Sunflowers	95.46	0.00	2014
Soybeans	117.95	0.00	29
<b>TOTAL</b>	<b>617.87</b>	<b>0.00</b>	

NOTES



SOUTH DAKOTA  
SULLY  
Form: FSA-156EZ



United States Department of Agriculture  
Farm Service Agency

Abbreviated 156 Farm Record

FARM : 5366  
Prepared : 6/22/22 3:48 PM  
Crop Year : 2022

Tract Number : 2249

Description : 34-114-76  
FSA Physical Location : SOUTH DAKOTA/SULLY  
ANSI Physical Location : SOUTH DAKOTA/SULLY  
BIA Unit Range Number :  
HEL Status : NHEL: No agricultural commodity planted on undetermined fields  
Wetland Status : Tract contains a wetland or farmed wetland  
WL Violations : None  
Owners : DEAN A NELSON FARMS INC  
Other Producers :  
Recon ID : None

Tract Land Data

Farm Land	Cropland	DCP Cropland	WBP	WRP	CRP	GRP	Sugarcane
625.51	616.86	616.86	0.00	0.00	0.00	0.00	0.00
State Conservation	Other Conservation	Effective DCP Cropland	Double Cropped	MPL	EWP	DCP Ag. Rel Activity	Broken From Native Sod
0.00	0.00	616.86	0.00	0.00	0.00	0.00	0.00

DCP Crop Data

Crop Name	Base Acres	CCC-505 CRP Reduction Acres	PLC Yield
Wheat	306.40	0.00	46
Corn	94.66	0.00	99
Sunflowers	94.66	0.00	2014
Soybeans	116.96	0.00	29

TOTAL 612.68 0.00

NOTES

Tract Number : 2250

Description : 35-114-76  
FSA Physical Location : SOUTH DAKOTA/SULLY  
ANSI Physical Location : SOUTH DAKOTA/SULLY  
BIA Unit Range Number :  
HEL Status : NHEL: No agricultural commodity planted on undetermined fields  
Wetland Status : Tract contains a wetland or farmed wetland  
WL Violations : None  
Owners : DEAN A NELSON FARMS INC  
Other Producers :  
Recon ID : None

Tract Land Data

Farm Land	Cropland	DCP Cropland	WBP	WRP	CRP	GRP	Sugarcane
634.18	632.64	632.64	0.00	0.00	0.00	0.00	0.00
State Conservation	Other Conservation	Effective DCP Cropland	Double Cropped	MPL	EWP	DCP Ag. Rel Activity	Broken From Native Sod
0.00	0.00	632.64	0.00	0.00	0.00	0.00	0.00

SOUTH DAKOTA  
SULLY  
Form: FSA-156EZ



United States Department of Agriculture  
Farm Service Agency

Abbreviated 156 Farm Record

FARM : 5366  
Prepared : 6/22/22 3:48 PM  
Crop Year : 2022

Tract 2250 Continued ...

DCP Crop Data

Crop Name	Base Acres	CCC-505 CRP Reduction Acres	PLC Yield
Wheat	314.42	0.00	46
Corn	97.12	0.00	99
Sunflowers	97.12	0.00	2014
Soybeans	120.01	0.00	29

**TOTAL** **628.67** **0.00**

NOTES

In accordance with Federal civil rights law and U.S. Department of Agriculture (USDA) civil rights regulations and policies, the USDA, its Agencies, offices, and employees, and institutions participating in or administering USDA programs are prohibited from discriminating based on race, color, national origin, religion, sex, gender identity (including gender expression), sexual orientation, disability, age, marital status, family/parental status, income derived from a public assistance program, political beliefs, or reprisal or retaliation for prior civil rights activity, in any program or activity conducted or funded by USDA (not all bases apply to all programs). Remedies and complaint filing deadlines vary by program or incident.

Persons with disabilities who require alternative means of communication for program information (e.g., Braille, large print, audiotape, American Sign Language, etc.) should contact the responsible Agency or USDA's TARGET Center at (202) 720-2600 (voice and TTY) or contact USDA through the Federal Relay Service at (800) 877-8339. Additionally, program information may be made available in languages other than English.

To file a program discrimination complaint, complete the USDA Program Discrimination Complaint Form, AD-3027, found online at [http://www.ascr.usda.gov/complaint\\_filing\\_cust.html](http://www.ascr.usda.gov/complaint_filing_cust.html) and at any USDA office or write a letter addressed to USDA and provide in the letter all of the information requested in the form. To request a copy of the complaint form, call (866) 632-9992. Submit your completed form or letter to USDA by: (1) mail: U.S. Department of Agriculture Office of the Assistant Secretary for Civil Rights 1400 Independence Avenue, SW Washington, D.C. 20250-9410; (2) fax: (202) 690-7442; or (3) e-mail: [program.intake@usda.gov](mailto:program.intake@usda.gov). USDA is an equal opportunity provider, employer, and lender.



SOUTH DAKOTA  
SULLY  
Form: FSA-156EZ



United States Department of Agriculture  
Farm Service Agency

FARM : 5397  
Prepared : 6/22/22 3:49 PM  
Crop Year : 2022

See Page 4 for non-discriminatory Statements.

### Abbreviated 156 Farm Record

Operator Name :  
Farms Associated with Operator :  
CRP Contract Number(s) : None  
Recon ID : 46-119-2022-113  
Transferred From : None  
ARCPLC G/I/F Eligibility : Eligible

#### Farm Land Data

Farmland	Cropland	DCP Cropland	WBP	WRP	CRP	GRP	Sugarcane	Farm Status	Number Of Tracts
1,893.90	1,848.47	1,848.47	0.00	0.00	0.00	0.00	0.00	Active	4
State Conservation	Other Conservation	Effective DCP Cropland	Double Cropped		MPL	Acre Election	EWP	DCP Ag.Rel. Activity	Broken From Native Sod
0.00	0.00	1,848.47	0.00		0.00		0.00	0.00	0.00

#### Crop Election Choice

ARC Individual	ARC County	Price Loss Coverage
None	CORN, SOYBN	WHEAT, SNFLR

#### DCP Crop Data

Crop Name	Base Acres	CCC-505 CRP Reduction Acres	PLC Yield	HIP
Wheat	918.18	0.00	46	
Corn	283.67	0.00	99	0
Sunflowers	283.67	0.00	2014	
Soybeans	350.50	0.00	29	0
<b>TOTAL</b>	<b>1836.02</b>	<b>0.00</b>		

#### NOTES

--

Tract Number : 2246

Description : W-26-114-76  
FSA Physical Location : SOUTH DAKOTA/SULLY  
ANSI Physical Location : SOUTH DAKOTA/SULLY  
BIA Unit Range Number :  
HEL Status : NHEL: No agricultural commodity planted on undetermined fields  
Wetland Status : Tract contains a wetland or farmed wetland  
WL Violations : None  
Owners : DEAN A NELSON FARMS INC  
Other Producers : None  
Recon ID : None

#### Tract Land Data

Farm Land	Cropland	DCP Cropland	WBP	WRP	CRP	GRP	Sugarcane
320.38	308.17	308.17	0.00	0.00	0.00	0.00	0.00
State Conservation	Other Conservation	Effective DCP Cropland	Double Cropped	MPL	EWP	DCP Ag. Rel Activity	Broken From Native Sod
0.00	0.00	308.17	0.00	0.00	0.00	0.00	0.00

SOUTH DAKOTA  
SULLY  
Form: FSA-156EZ



United States Department of Agriculture  
Farm Service Agency

Abbreviated 156 Farm Record

FARM : 5397  
Prepared : 6/22/22 3:49 PM  
Crop Year : 2022

DCP Crop Data

Tract 2246 Continued ...

Crop Name	Base Acres	CCC-505 CRP Reduction Acres	PLC Yield
Wheat	153.10	0.00	46
Corn	47.30	0.00	99
Sunflowers	47.30	0.00	2014
Soybeans	58.44	0.00	29
<b>TOTAL</b>	<b>306.14</b>	<b>0.00</b>	

NOTES

Tract Number : 2247

Description : 27-114-76  
FSA Physical Location : SOUTH DAKOTA/SULLY  
ANSI Physical Location : SOUTH DAKOTA/SULLY  
BIA Unit Range Number :  
HEL Status : NHEL: No agricultural commodity planted on undetermined fields  
Wetland Status : Tract contains a wetland or farmed wetland  
WL Violations : None  
Owners : DEAN A NELSON FARMS INC  
Other Producers : None  
Recon ID : None

Tract Land Data

Farm Land	Cropland	DCP Cropland	WBP	WRP	CRP	GRP	Sugarcane
631.87	631.87	631.87	0.00	0.00	0.00	0.00	0.00
State Conservation	Other Conservation	Effective DCP Cropland	Double Cropped	MPL	EWP	DCP Ag. Rel Activity	Broken From Native Sod
0.00	0.00	631.87	0.00	0.00	0.00	0.00	0.00

DCP Crop Data

Crop Name	Base Acres	CCC-505 CRP Reduction Acres	PLC Yield
Wheat	313.81	0.00	46
Corn	96.95	0.00	99
Sunflowers	96.95	0.00	2014
Soybeans	119.79	0.00	29
<b>TOTAL</b>	<b>627.50</b>	<b>0.00</b>	

NOTES

SOUTH DAKOTA  
SULLY  
Form: FSA-156EZ



United States Department of Agriculture  
Farm Service Agency

Abbreviated 156 Farm Record

FARM : 5397  
Prepared : 6/22/22 3:49 PM  
Crop Year : 2022

Tract Number : 3438

Description : E-28-114-76  
FSA Physical Location : SOUTH DAKOTA/SULLY  
ANSI Physical Location : SOUTH DAKOTA/SULLY  
BIA Unit Range Number :  
HEL Status : NHEL: No agricultural commodity planted on undetermined fields  
Wetland Status : Tract contains a wetland or farmed wetland  
WL Violations : None  
Owners : DEAN A NELSON FARMS INC  
Other Producers : None  
Recon ID : None

Tract Land Data

Farm Land	Cropland	DCP Cropland	WBP	WRP	CRP	GRP	Sugarcane
322.16	314.75	314.75	0.00	0.00	0.00	0.00	0.00
State Conservation	Other Conservation	Effective DCP Cropland	Double Cropped	MPL	EWP	DCP Ag. Rel Activity	Broken From Native Sod
0.00	0.00	314.75	0.00	0.00	0.00	0.00	0.00

DCP Crop Data

Crop Name	Base Acres	CCC-505 CRP Reduction Acres	PLC Yield
Wheat	156.30	0.00	46
Corn	48.29	0.00	99
Sunflowers	48.29	0.00	2014
Soybeans	59.67	0.00	29
<b>TOTAL</b>	<b>312.55</b>	<b>0.00</b>	

NOTES

Tract Number : 4045

Description : 2-113-76 less Tract 1  
FSA Physical Location : SOUTH DAKOTA/SULLY  
ANSI Physical Location : SOUTH DAKOTA/SULLY  
BIA Unit Range Number :  
HEL Status : NHEL: No agricultural commodity planted on undetermined fields  
Wetland Status : Tract contains a wetland or farmed wetland  
WL Violations : None  
Owners : DEAN A NELSON FARMS INC  
Other Producers : None  
Recon ID : None

Tract Land Data

Farm Land	Cropland	DCP Cropland	WBP	WRP	CRP	GRP	Sugarcane
619.49	593.68	593.68	0.00	0.00	0.00	0.00	0.00
State Conservation	Other Conservation	Effective DCP Cropland	Double Cropped	MPL	EWP	DCP Ag. Rel Activity	Broken From Native Sod
0.00	0.00	593.68	0.00	0.00	0.00	0.00	0.00



SOUTH DAKOTA  
SULLY  
Form: FSA-156EZ



United States Department of Agriculture  
Farm Service Agency

Abbreviated 156 Farm Record

FARM : 5397  
Prepared : 6/22/22 3:49 PM  
Crop Year : 2022

Tract 4045 Continued ...

DCP Crop Data			
Crop Name	Base Acres	CCC-505 CRP Reduction Acres	PLC Yield
Wheat	294.97	0.00	46
Corn	91.13	0.00	99
Sunflowers	91.13	0.00	2014
Soybeans	112.60	0.00	29
<b>TOTAL</b>	<b>589.83</b>	<b>0.00</b>	

NOTES

In accordance with Federal civil rights law and U.S. Department of Agriculture (USDA) civil rights regulations and policies, the USDA, its Agencies, offices, and employees, and institutions participating in or administering USDA programs are prohibited from discriminating based on race, color, national origin, religion, sex, gender identity (including gender expression), sexual orientation, disability, age, marital status, family/parental status, income derived from a public assistance program, political beliefs, or reprisal or retaliation for prior civil rights activity, in any program or activity conducted or funded by USDA (not all bases apply to all programs). Remedies and complaint filing deadlines vary by program or incident.

Persons with disabilities who require alternative means of communication for program information (e.g., Braille, large print, audiotope, American Sign Language, etc.) should contact the responsible Agency or USDA's TARGET Center at (202) 720-2600 (voice and TTY) or contact USDA through the Federal Relay Service at (800) 877-8339. Additionally, program information may be made available in languages other than English.

To file a program discrimination complaint, complete the USDA Program Discrimination Complaint Form, AD-3027, found online at [http://www.ascr.usda.gov/complaint\\_filing\\_cust.html](http://www.ascr.usda.gov/complaint_filing_cust.html) and at any USDA office or write a letter addressed to USDA and provide in the letter all of the information requested in the form. To request a copy of the complaint form, call (866) 632-9992. Submit your completed form or letter to USDA by: (1) mail: U.S. Department of Agriculture Office of the Assistant Secretary for Civil Rights 1400 Independence Avenue, SW Washington, D.C. 20250-9410; (2) fax: (202) 690-7442; or (3) e-mail: [program.intake@usda.gov](mailto:program.intake@usda.gov). USDA is an equal opportunity provider, employer, and lender.

## NOTES